

News

since October 2018

Article:	Fits for:	Order no.:		EUR without Tax	EUR incl. 19% Tax
For Yamaha MT-07 (with indicator on the cooler cover), (RM17) 2019-					
Protection Guard, below, black		7534 SE YA MT-07 Tracer	Pair	117,90	140,30
Baggage holder, black		7488 P YA MT-07	Pair	69,45	82,65
Luggage carrier, black		7489 G YA MT-07	Piece	110,25	131,20

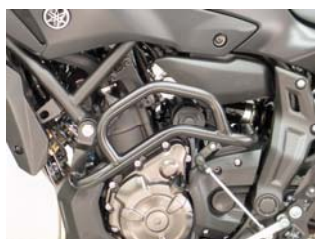

7534 SE YA MT-07 Tracer



7488 P YA MT-07



7489 G YA MT-07

Handlebar with strut

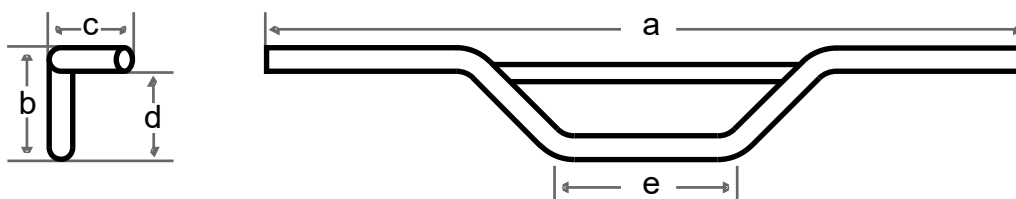

Article:		Order no.:		EUR without Tax	EUR incl. 19% Tax
Handlebar with strut from tube 25,4 mm Ø (1"),					
with notch for cables and 3 holes for inside wiring (for all HD 82 up),					
(one long hole 13 x 30 in the cable notches and 1 long hole 13 x 40 in the middle of the mounting place)					
Inclusive Technical Report for registration pursuant § 19 (2) (§ 21).					

Handlebar like CL 9 HD with strut 22 mm Ø:									
Handlebar with rounded strut Ø 22 mm	870	145	205	160	7670 CL 10 HD MK 3Loch	Piece	73,15	87,05	
Dto., black					7672 CL 10 HD MK 3Loch, schwarz	Piece	73,15	87,05	

Handlebar with strut from tube 31,75 mm Ø (1 1/4"), grips and clamping range 25,4 mm Ø (1")									
with notch for cables and 3 holes for inside wiring (for all HD 82 up),									
(one long hole 13 x 30 in the cable notches and 1 long hole 13 x 40 in the middle of the mounting place)									
Inclusive Technical Report for registration pursuant § 19 (2) (§ 21).									

Handlebar round above, below angular	890	100	250	145	7665 CL 20 FB MK 3Loch	Piece	149,75	178,20	
Dto., black					7669 CL 20 FB MK 3Loch, schwarz	Piece	149,75	178,20	



7670+7672



7669 HD Street Bob
Side 1



7665+7669



New MSP-handlebars with ABE

without modification acceptance

For the MSP-Handlebars with ABE exist a use list with models of Chopper, Cruiser and Classic Bikes from Harley-Davidson, Honda, Kawasaki, Suzuki, Triumph, Victory and Yamaha.

MSP-CrackBar

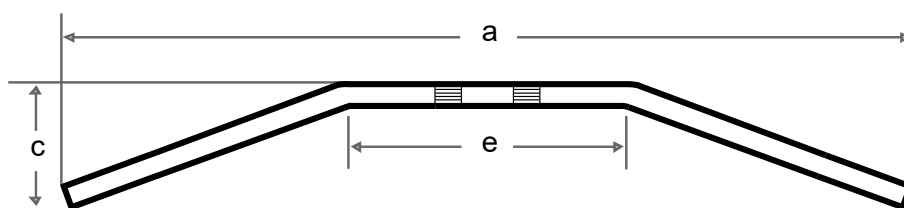

Article:	Order no.:	EUR without Tax	EUR incl. 19% Tax
Crackbars from tube 25,4 mm Ø (1"), with notch for cables (for all HD 82 up)	a c e		
CrackBar, 800 mm breit, black	800 120 240 6240 MSP-RL-1-B1-B-A-C schw. Piece	61,85	73,60

MSP-CustomBar

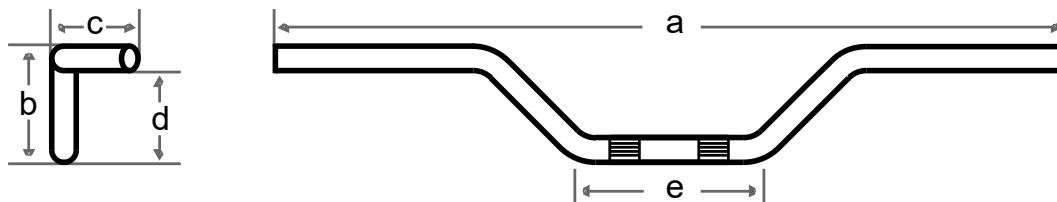

Article:	Order no.:	EUR without Tax	EUR incl. 19% Tax
Custombars from tube 25,4 mm Ø (1"), with notch for cables (for all HD 82 up)	a b c d e		
CustomBar, high, black	800 90 115 80 160 6241 MSP-RL-1-A3-B-A-C schw. Piece	71,60	85,20

MSP-ZBars

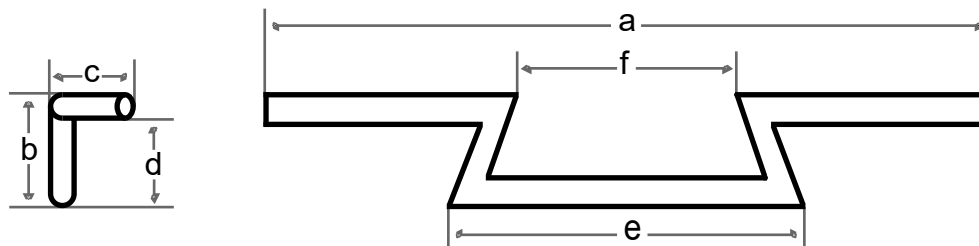

Article:	Order no.:	EUR without Tax	EUR incl. 19% Tax
ZBars aus Rohr 25,4 mm Ø (1"), with notch for cables (for all HD 82 up)	a b c d e		
ZBar,low, black	800 70 120 40 265 6242 MSP-RL-1-Z1-B-A-C schw. Piece	139,45	165,95
ZBar, high, black	800 110 120 80 265 6243 MSP-RL-1-Z2-B-A-C schw. Piece	142,35	169,40

Changes/corrections

Technical Change:

All handlebars with 5-hole system for inside wiring will be converted to the 3-hole system in new production (without longhole for inside wiring through the riser)

Z-Handlebar

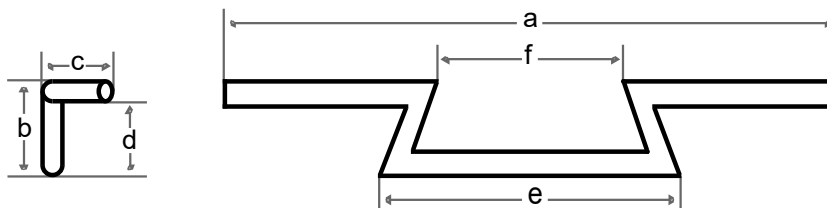

Z-Handlebar for Chopper and Cruiser from tube 25,4 mm Ø (1") with notch for cables (for all HD from year 82 up). 5 holes for inside wiring (1 slot per side in the notch in the grip end, 2 x in the mounting place and 1 x in the middle of mounting place).

Inclusive Technical Report for registration pursuant § 19 (2) (§ 21).

Article:	Order no.:					EUR without Tax	EUR incl. 19% Tax	
	a	b	c	d	e			
Z-handlebar, low, small,	870	85	120	50	300	7764 L Z 7 HD	Piece 144,20	171,60
Dto., black						7752 L Z 7 HD, schwarz	Piece 144,20	171,60

Changed to 3 hole cable inside wiring (1 longhole in the cable notch, in the grip area and 1 x in the middle of the mounting place).

Handlebars for Choppers and Cruisers from tube 31,75 mm Ø (1 1/4") with butted grip ends 25,4 mm Ø (1"). Length of the grip ends 200 mm, with notch for cables (For all HD from 82 up), 5 holes for inside wiring (1 longhole 10 x 20 mm in the wirenotch in the range of the grips, 2 x in the range of fixation (across pricked out for a greater mounting range by inside wiring through the Riser) and 1 x centric between the mounting points).

Changed to 3 hole cable inside wiring (Whitout cross hole for cable inside wiring through the riser).

Article:	Order no.:					EUR without Tax	EUR incl. 19% Tax	
	a	b	c	d	e			
Handlebar, flat and wide	995	65	200	115	180	7632 LN 69 HDF	Piece 142,90	170,05
Dto., black						7633 LN 69 HDF schwarz	Piece 142,90	170,05
Handlebar, flat and wide	1070	70	225	125	180	7634 LN 70 HDF	Piece 142,90	170,05
Dto., black						7635 LN 70 HDF schwarz	Piece 142,90	170,05
Handlebar, flat and wide	1000	65	230	120	215	7636 LN 71 HDF	Piece 142,90	170,05
Dto., black						7637 LN 71 HDF schwarz	Piece 142,90	170,05

Deleted items

Article:	fits for:	Order no.:
For Harley Davidson Sportster Evo 883/1200 (Custom, Roadster/Low, Nightster/Iron), 2004- Sissy Bar special with pad and side plates	Custom, Roadster/Low	7104RS HD Sportster Evo
For Harley Davidson Sportster SuperLow 1200T, (XL1200T) 2014- Rearrack		7073 RR HD Sportster SuperLow 1200 T
For Harley Davidson Dyna Street Bob, (FXDB) 2009-2013, (FXDB/14) 2014-2017 Only by the model Dyna Street Bob the rear was changed in 2009 (identified at the round taillight and Fender struts without cover). The Protection Guards are compatible with the Dyna models from year 2006 up, all accessories from the rear are new! Baggage Holder		7877 P HD Dyna Street Bob Bj. 09
For Harley Davidson Dyna Fat Bob, (FXDF) 2008-2013 and (FXDF/14) 2014-2017 Protection Guard one piece from tube 38 mm, conical form Dto., black Together with a solo seat fits also the Driver Sissy Bar of Dyna Wide Glide, (FXDWG) 2010-2017 Driver Sissy Bar with pad and carrier Dto., black		7869 DGX4 HD Dyna Fat Bob 7888 DGX4 HD Dyna Fat Bob, schwarz 6039 FRG HD Dyna Wide Glide Bj. 10 7892 FRG HD Dyna Wide Glide Bj. 10, schw.
For Harley Davidson Dyna Wide Glide, (FXDWG) 2010-2017 Protection Guard one piece from tube 38 mm, conical form Dto., black Driver Sissy Bar with pad and carrier Dto., black		7869 DGX4 HD Dyna Fat Bob 7888 DGX4 HD Dyna Fat Bob, schwarz 6039 FRG HD Dyna Wide Glide Bj. 10 7892 FRG HD Dyna Wide Glide Bj. 10, schw.
For Harley Davidson Dyna Glide Low Rider, (FXDL) 2015-2017 Protection Guard one piece from tube 38 mm, conical form Dto., black Baggage Holder		7869 DGX4 HD Dyna Fat Bob 7888 DGX4 HD Dyna Fat Bob, schwarz 7877 P HD Dyna Street Bob Bj. 09
For Harley Davidson Softail Slim, (FLS) 2012-2017 and Softail Blackline, (FXS) 2011-2013 Sissy Bar Special with pad and side plates, black Lugagge carrier for Sissy Bar Special, black		6053 RS HD Softail Blackline schwarz 6055 GRS HD Softail Blackline schwarz
For Harley Davidson Breakout (FXSB) 2013-2017 Baggage Holder		6190 P HD Breakout
For Harley Davidson Softail Deluxe (Milwaukee-Eight 107/114), (FLDE) 2018- Cover for regulator case, stainless steel Cover for oil cooler, stainless steel		6227 Blende Regler Softail M8 FLHC 6228 Ölkühlerblende Softail M8 FLHC
For Harley Davidson Softail Fat Boy (Milwaukee-Eight 107/114), (FLFB) 2018- and Breakout (Milwaukee-Eight 107/114), (FXBR) 2018- Cover for regulator case, stainless steel Cover for oil cooler, stainless steel		6227 Blende Regler Softail M8 FLHC 6228 Ölkühlerblende Softail M8 FLHC
For Harley Davidson Softail Heritage Classic (Milwaukee-Eight 107/114), (FLHC) 2018- Cover for regulator case, stainless steel Cover for oil cooler, stainless steel		6227 Blende Regler Softail M8 FLHC 6228 Ölkühlerblende Softail M8 FLHC

**For Honda CB 500 F, (PC45) 2013-
 and CB 500 X, (PC46) 2013-**
 Luggage Carrier, black

7939 G HO CB 500 F

For Honda VT 750 S (Chain), (RC58) 2010-2011
 Rearrack

7306 RR HO VT 750 S

**For Honda CRF 1000 L Africa Twin (also DCT) (SD04) 2016 and (SD06) 2017
 and CRF 1000 L Africa Twin (also DCT) (SD06) 2018-**

Case Holder „flex“, black	2016-2017	6206 K HO CRF 1000 L Africa Twin
Case Holder „flex“, black	2018-	6237 K HO CRF 1000 L Africa Twin 18
Far travel carrier, black	2016-2017	6207 Fernreiseträger HO CRF 1000 L
Far travel carrier, black	2018--	6238 Fernreiseträger HO CRF1000L18
Cover for brake fluid reservoir, rear, stainless steel, 2018-		6239 Behälterschutz hi. CRF1000L18

For Honda Varadero XL 1000 V, (SD02) 2002 and (SD02) 2003-2006

Enduro Protection Guard, black XL 1000 V ab Bj. 03 7333 ES HO XL 1000V Varadero Bj.03

For Piaggio MP3 LT 500 i.e. New ABS-ASR Sport/Business, (M861) 2014-

Protection Guard front 6167 SV PI MP3 LT 500 i.e. New ABS-ASR
 (Protection Guard, front 6167 can only be mounted together with the Side Guard 6168.)

**For Suzuki AN 400 Burgman, (WVCG) 2007-2009
 and AN 400 Burgman Z ABS, (WVCG/10) 2010-**

Protection Guard, front 7813 SV SU AN 400 Burgman Bj. 07

**For Triumph Bonneville T 100 and SE, (986MF) 2005-2016
 and Scrambler, (986MG2) 2008-2016**

Side Case Holder for Givi/Kappa (Monokey) Cases 6080 ST TR Bonneville T 100

For Triumph Bonneville T 100, (70G) 2017-
 Seat Border

6184 SU TR Bonneville T 100 Bj. 17

For Triumph Bonneville T 120, (75HW) 2016-
 Luggage Carrier, black

7923 G TR Bonneville T 120, schwarz

For Yamaha XV 950 R, (VN036) 2014-
 Mounting Bar for additional spotlights, black

6137 LH YA XV 950 R

For Yamaha XVS 1300 Midnight Star, (VP26) 2007-
 Solo Rack from sheet metal

6003 BRB YA XVS 1300

Z-handlebar

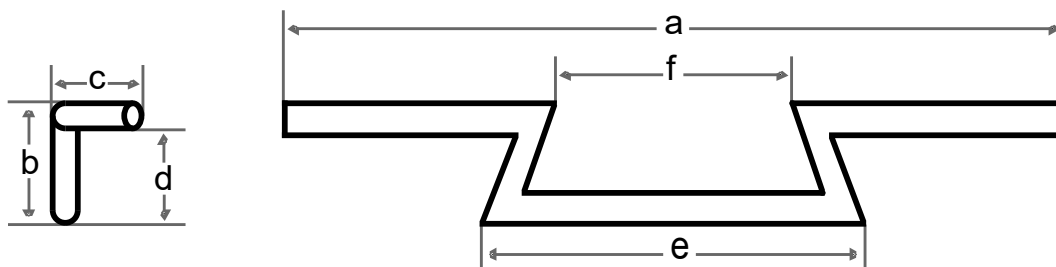

Article:

Order no.:

**Z-Fatbar from tube 31,75 mm Ø (1 1/4") with grip ends 25,4 mm Ø (1").
 Model for Harley-Davidson with Throttle by Wire (TBW)**

Z-Fatbar, high, small, black	850	145	120	110	300	7262 L Z 9 HDF-E, schwarz
------------------------------	-----	-----	-----	-----	-----	---------------------------