

English Pricelist

· MOTORRADZUBEHÖR ·

FEHLING



Januar 2024

Preisliste

Lenker
Schutzbügel
Gepäckträger
Chrom & Parts

Zertifiziert DIN EN ISO 9001



MÜLLER MOTORCYCLE AG

Riser / Lenkerhalter

Zur Erweiterung unseres Programms und als Ergänzung zu unseren Motorradlenkern haben wir von der Firma Müller Motorcycle AG die Produktlinie der Riser übernommen. Die Riser haben eine schöne Optik und sind sauber verarbeitet. Die Riserdeckel sind unsichtbar von unten verschraubt. Gefertigt aus hochfestem Flugzeugaluminium. Damit haben Sie ihren Lenker jederzeit fest im Griff.

Die Riser gibt es für 25,4 mm (1") und 31,75 mm (1 ¼") Lenker, in 50, 75 und 100 mm Höhe, in poliert oder schwarz eloxiert. Mit 1/2" UNC Gewinde.

Für die Riser gibt es ein Teilegutachten zur Eintragung nach § 19 (3)



Riser 50 mm hoch

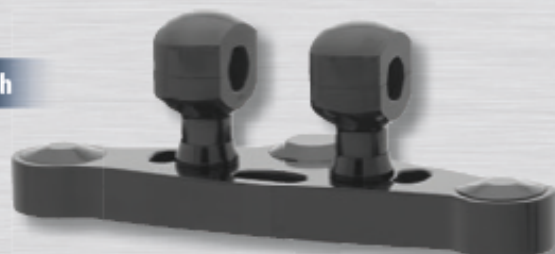

Riser 75 mm hoch

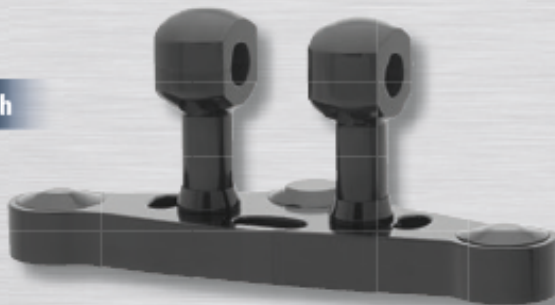

Riser 100 mm hoch

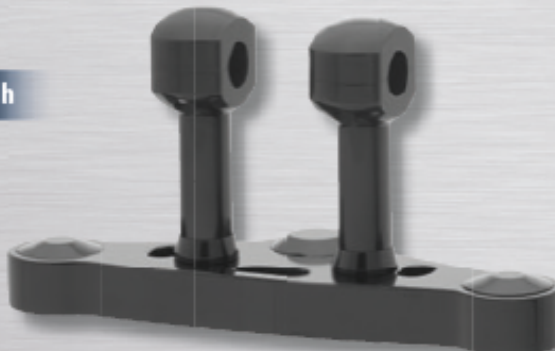

Motorcycle Accessories for:

	Side
BMW	5
Daelim	6
Ducati	6
Harley-Davidson	7-13
Honda	14-18
Kawasaki	19-21
Piaggio / Vespa	21
Suzuki	22-23
Triumph	24-27
Victory	27
Yamaha	27-31
Accessories	32

Handlebar holder / Riser

Ø 25,4 mm (1“) and Ø 31,75 mm (1 1/4“)	33
---	----

Motorcycle Handlebars

Ø 22 mm (7/8“)	34-38
Ø 25,4 mm (1“)	39-46
Ø 31,75 mm (1 1/4“), Grip ends and clamping Ø 25,4 mm (1“)	46
Ø 31,75 mm (1 1/4“), Grip ends Ø 25,4 mm (1“)	47-49
MSP-Handlebars with ABE, Ø 25,4 mm (1“) and Ø 31,75 mm (1 1/4“), Grip ends Ø 25,4 mm (1“)	50-51
Info about handlebars and technical reports	52-53
Options of manufacturing	52-53

Price- and Shipping information	55
--	----

Explanation of the short name

All artikels are high-gloss nickel and chrome plated,
Exceptions are indicated in the price list!

The required mounting parts are supplied, excluding handlebars.

Protection Guard:

- D** Protection Guard, 1 piece made from 22 or 25 mm tube
- D** Protection Guard, 2 pcs. made from tube 25 mm with additional bracket to the rear
- DG** Protection Guard, 1 piece, big design made from tube 30 or 32 mm
- DGX** Protection Guard, 1 piece, extra big design made from tube 38 mm
- E** Protection Guard, 1 piece made from tube 22 or 25 mm
- M** Engine Guard made from tube 25 mm (2-point mounting)
- MS** Engine Guard solid, made from tube 25 mm (3-point mounting)
- SE** Protection Guard, different designs made from tube 22 or 25 mm with 2- or 3-point mounting
- Z** Decorative Protection Guard, or cylinder head guard, 2 pcs. made from tube 22 or 25 mm (3-Point mounting)
- ES** Enduro Protection Guard made from tube 22 or 25 mm
- H** Rear Protection Guards for sidecases
- SS** Side Guards for scooters made from tube 18 mm

Luggage Carrier:

- G** Luggage Carrier made from tube 16 or 18 mm (Maximum load 5 kg)
- RR** Rearrack, smal petit chopper carrier made from tube 12 mm (Maximum load 5 kg)
- BR** Solo-Rack, smal carrier from 12 mm tube which can be changed with the passenger seat (Maximum load. 5 kg)
- BRB** Solo-Rack, with sheet metal support (Maximum load 5 kg)

Topcase- and Side Carrier:

for Givi/Kappa (Monokey) cases (inclusive fastener kit) (Not for Trekker Dolomiti):
(Will not fit for "Monokey Side" Cases (V35/37))

- TT** Topcase Carrier made from tube 18 mm (Maximum load 5 kg)
- ST** Side Case Carrier made from tube 16 mm, (Maximum load 2 x 10 kg, single sided 5 kg)
(Side Case Carrier and Topcase Carrier can not be mounted together with our other parts for the motorcycle rear)

Case Carrier „flex“:

for Givi/Kappa (Monokey) Case (inclusive fastener kit) (Not for Trekker Dolomiti)
(Will not fit for "Monokey Side" Cases (V35/37))

for Hepco & Becker Cases Junior, Journey, Gobi and Explorer (Lock plate is included with the case)

for SW-Motech Cases Trax, Trax Evo and Aero (in combination with original SW-Motech fastener kit)

- K** Case Carrier „flex“, made from tube 16 mm, (Maximum load 2 x 10 kg bzw. single sided 5 kg)
- T** Topcase Carrier „flex“, made from metal sheet with 16 mm tube border and screw on grip bracket (Max. load 5 kg)
(Side Case Carrier and Topcase Carrier can not be mounted together with our other parts for the motorcycle rear)

Sissy Bars:

- RG** Sissy Bar 20 cm high, made of tube, with pad and carrier (.Maximum. load 5 kg)
- R2** Sissy Bar 20 cm high, made of tube, with pad
- BRG** Codriver Sissy Bar 20 cm high, made of tube, with pad and carrier (Maximum load 5 kg)
- FR** Driver Sissy Bar 20 cm high, with pad
- FRG** Driver Sissy Bar 20 cm high, made of tube, with pad and carrier (Maximum load 5 kg)

Chromparts / Other accessories:

- P** Baggage Holder, some with turn signal relocation
- RL** Fender Guard, front
- LBU** Headlight Protector
- LH** Mounting Bar additional Spotlights up to 132 mm ø
- KA** Radiator Cover from sheet metal
- ZB** Deco Cover from sheet metal
- HG** Hand Grip
- SU** Seat Border

And many other articles made of tube or sheet metal

We recommend a maximum speed of 130km/h loaded with Topcase, Cases or Baggage

BMW

Article:	Fits for:	Order No.:		EUR without Tax	EUR incl. 19% Tax
For BMW R 50, R 50/2, R 60, R 60/2, R 68, R 69, R 69 S Cylinder Head Engine Guard pair		7144 Z BMW 3	Pair	217,65	259,00
For BMW R 80, R 80/100 G/S, R 80 ST, R 100 (S, T, CS), R 90 S, /5, /6, /7 Cylinder Head Engine Guard pair. (The cylinder head engine guard will not fit for models with SLS System)		7160 Z BMW R 80 G/S	Pair	217,65	259,00
For BMW F 650 GS, (172/173) 2000-2003 Offroad Protection Guard, silver		7177 ES BMW F 650 GS	Pair	193,92	230,76
For BMW R 1150 GS, (R21) 1999-2004 Offroad Protection Guard, silver		7173 ES BMW R 1150 GS	Pair	241,13	286,94
For BMW R 18 (OL11) 2021- Cylinder Head Engine Guard pair		6278 Z BMW R 18	Pair	251,69	299,51
Cylinder Head Engine Guard pair, black		6279 Z BMW R 18 schwarz	Pair	251,69	299,51
Solo-Rack Ø 16		6280 BR BMW R 18	Piece	127,12	151,27
Solo-Rack Ø 16, black		6281 BR BMW R 18 schwarz	Piece	127,12	151,27
Baggage Holder Ø 16		6284 P BMW R 18	Pair	95,04	113,10
Baggage Holder Ø 16, black		6285 P BMW R 18 schwarz	Pair	95,04	113,10
Sissy Bar made from tube with pad and carrier		6286 RG BMW R 18	Piece	236,31	281,21
Sissy Bar made from tube with pad and carrier, black		6287 RG BMW R 18 schwarz	Piece	236,31	281,21
Driver Sissy Bar with big rounded pad and carrier		6288 FRG BMW R 18	Piece	292,13	347,63
Driver Sissy Bar with big rounded Pad and Carrier., black		6289 FRG BMW R 18 schwarz	Piece	292,13	347,63
Mounting Bar for additional Spotlights		6290 LH BMW R 18	Piece	69,36	82,54
Mounting Bar for additional Spotlights, black		6291 LH BMW R 18 schwarz	Piece	69,36	82,54



6278 Z BMW R 18



6279 Z BMW R 18



6280 BR BMW R 18



6284 P BMW R 18



6286 RG BMW R 18



6288 FRG BMW R 18



6288 FRG BMW R 18



6290 LH BMW R 18

Daelim

Article:	Fits for:	Order No.:		EUR without Tax	EUR incl. 19% Tax
For Daelim VL 125 Daystar, (VL125DAYST) 2000-2005 and Daystar 125 FI, (DAYST125FI) 2007-2020					
Protection Guard		7081 D DAE VL 125 Daystar	Piece	133,90	159,34
Baggage Holder		7078 P DAE VL 125 Daystar	Pair	95,04	113,10

Ducati

Article:	Fits for:	Order No.:		EUR without Tax	EUR incl. 19% Tax
For Ducati Scrambler 800 Classic, (SCRAM) 2015-2016 and (SCRM/17) 2017-2018					
Engine Protection Guard, black		7819 SE DU Scrambler Classic	Pair	161,16	191,78
Baggage Holder, black		7820 P DU Scrambler Classic	Pair	95,04	113,10
Luggage Carrier, black		7821 G DU Scrambler Classic	Piece	150,91	179,58
Protection for controller cover, stainless steel		7822 Gehäuse Regler DU Scrambler	Piece	49,78	59,24
Protection for oil cooler, stainless steel		7823 Schutz Ölkühler DU Scrambler	Piece	49,78	59,24



7819 SE DU Scrambler Classic



7820 P DU Scrambler Classic



7821 G DU Scrambler Classic



7822 Controller Cover Scrambler



7823 Oil Cooler Protection Scrambler

Harley-Davidson

Article:	Fits for:	Order No.:		EUR without Tax	EUR incl. 19% Tax
For Harley Davidson Sportster 883/1200 (Custom, Roadster), 1988-2003					
Protection Guard, tube 30 mm		7044 D HD Sportster Custom	Piece	193,92	230,76
Baggage Holder		7043 P HD Sportster	Pair	95,04	113,10
For Harley Davidson Sportster Evo 883/1200 (Custom, Roadster/Low, Nightster/Iron), 2004-2020					
Protection Guard tube 38 mm	Custom, Roadster/Low, Nightster/Iron	7046 DGX HD Sportster Evo	Piece	256,20	304,88
Dto., black	Custom, Roadster/Low, Nightster/Iron	7228 DGX HD Sportster Evo, schwarz	Piece	256,20	304,88
Baggage Holder	Custom, Roadster/Low, Nightster/Iron	7231 P HD Sportster Evo	Pair	95,04	113,10
Dto., black	Custom, Roadster/Low, Nightster/Iron	7232 P HD Sportster Evo, schwarz	Pair	95,04	113,10
Rearrack	Custom, Roadster/Low	7049 RR HD Sportster Evo	Piece	107,24	127,62
(The Rearrack fits not for Sportster Evo Custom 1200 (XL1200C) 2011-2020)					
Solo-Rack	Custom, Roadster/Low	7075 BR HD Sportster Evo	Piece	127,12	151,27
(The Solo-Rack 7075 can be combined with the Rearrack 7049)					
Solo-Rack, black	Custom, Roadster/Low, Nightster/Iron	7230 BR HD Sportster Evo Nightster, schw.	Piece	127,12	151,27
(The Solo-Rack 7230 can not be combined with the Rearrack 7049)					
Solo-Rack Ø 16, curved, black shiny for Iron		7117 BR HD Sportster 48 schwarz	Piece	127,12	151,27
(The Solo-Rack 7117 can not be combined with the Rearrack 7049)					
Driver Sissy Bar with pad and Carrier	Custom, Roadster/Low, Nightster/Iron	7233 FRG HD Sportster Evo	Piece	292,13	347,63
For Harley Davidson Sportster 1200 Custom, (XL1200C/11) 2011-2020 (with new LED rear light and changed licence plate holder)					
All other accessories except the Rearrack fit from the Sportster Evo Custom 883/1200 from year 2004 up					
Rearrack		7042 RR HD Sportster Custom 1200 Bj. 11	Piece	107,24	127,62
For Harley Davidson Sportster SuperLow 1200T, (XL1200T) 2014-2020					
Protection Guard, Baggage Holder and Solo-Rack fit from Sportster Evo 883/1200, 2004-2020					
For Harley Davidson Sportster Forty-Eight, (XL1200X) 2010-2020					
Protection Guard tube 38 mm		7046 DGX HD Sportster Evo	Piece	256,20	304,88
Dto., black		7228 DGX HD Sportster Evo, schwarz	Piece	256,20	304,88
Baggage Holder		7231 P HD Sportster Evo	Pair	95,04	113,10
Dto., black		7232 P HD Sportster Evo, schwarz	Pair	95,04	113,10
Solo-Rack Ø 16, curved, black shiny		7117 BR HD Sportster 48 schwarz	Piece	127,12	151,27
Solo Rack from sheet metal, black		7116 BRB HD Sportster 48 schwarz	Piece	127,12	151,27
Driver Sissy Bar with pad and Carrier, black		7130 FRG HD Sportster 48 schwarz	Piece	292,13	347,63



7117 BR HD Sportster 48 black

Article:	Fits for:	Order No.:		EUR without Tax	EUR incl. 19% Tax
For Harley Davidson Dyna Super Glide (Twin Cam), (FXD) 1999-2004 and Dyna Glide Low Rider (Twin Cam), (FXDL) 1999-2005					
Baggage Holder		7103 P HD Dyna Glide	Pair	95,04	113,10
Rearrack		7105 RR HD Dyna Glide	Piece	107,24	127,62
For Harley Davidson Dyna Modelle 2006-2017 (not for FXDWG Dyna Wide Glide and FXDF Dyna Fat Bob)					
Dto., black		7220 DGX HD Dyna Bj. 06, schwarz	Piece	267,73	318,60
Protection Guard one piece from tube 38 mm, round form		7223 DGX3 HD Dyna Bj. 06	Piece	267,73	318,60
Dto., black		7224 DGX3 HD Dyna Bj. 06, schwarz	Piece	267,73	318,60
Baggage Holder		7166 P HD Dyna Bj. 06	Pair	95,04	113,10
Dto., black		7225 P HD Dyna Bj. 06, schwarz	Pair	95,04	113,10
Rearrack		7167 RR HD Dyna Bj. 06	Piece	107,24	127,62
Dto., black		7170 RR HD Dyna Bj. 06, schwarz	Piece	107,24	127,62
Driver Sissy Bar with pad and carrier		7881 FRG HD Dyna Street Bob Bj. 09	Piece	292,13	347,63
Dto., black		7880 FRG HD Dyna Street Bob Bj. 09, schw.	Stück	292,13	347,63
For Harley Davidson Dyna Street Bob, (FXDB) 2009-2013, (FXDB/14) 2014-2017 Only by the model Dyna Street Bob the rear was changed in 2009 (identified at the round taillight and Fender struts without cover). The Protection Guards are compatible with the Dyna models from year 2006 up, all accessories from the rear are new!					
Baggage Holder, black		7878 P HD Dyna Street Bob Bj. 09, schwarz	Pair	95,04	113,10
Driver Sissy Bar with pad and carrier		7881 FRG HD Dyna Street Bob Bj. 09	Piece	292,13	347,63
Dto., black		7880 FRG HD Dyna Street Bob Bj. 09, schw.	Piece	292,13	347,63
For Harley Davidson Street Bob Special, (FXDBC) 2015-2017 All rear parts of Street Bob, (FXDB/14) 2014-2017 fit					
For Harley Davidson Dyna Fat Bob, (FXDF) 2008-2013 and (FXDF/14) 2014-2017					
Baggage Holder		7873 P HD Dyna Fat Bob	Pair	95,04	113,10
Rearrack		7874 RR HD Dyna Fat Bob	Piece	107,24	127,62
Dto., black		7890 RR HD Dyna Fat Bob, schwarz	Piece	107,24	127,62
Co-Driver Sissy Bar with pad and carrier		7875 BRG HD Dyna Fat Bob	Piece	292,13	347,63
Dto., black		7891 BRG HD Dyna Fat Bob, schwarz	Piece	292,13	347,63



7873 P HD Dyna Fat Bob



7890 RR HD Dyna Fat Bob, schwarz



7891 BRG HD Dyna Fat Bob, schwarz

For Harley Davidson Dyna Wide Glide, (FXDWG) 2010-2017

Solo-Rack		6037 BR HD Dyna Wide Glide Bj. 10	Piece	127,12	151,27
-----------	--	-----------------------------------	-------	--------	--------

For Harley Davidson Dyna Glide Low Rider, (FXDL) 2015-2017

Protection Guard one piece from tube 38 mm, squared form, black		7220 DGX HD Dyna Bj. 06, schwarz	Piece	267,73	318,60
Baggage Holder, black		7878 P HD Dyna Street Bob Bj. 09, schwarz	Pair	95,04	113,10
Rearrack		7167 RR HD Dyna Bj. 06	Piece	107,24	127,62
Dto., black		7170 RR HD Dyna Bj. 06, schwarz	Piece	107,24	127,62
Driver Sissy Bar with pad and carrier		7881 FRG HD Dyna Street Bob Bj. 09	Piece	292,13	347,63
Dto., black		7880 FRG HD Dyna Street Bob Bj. 09, schw.	Piece	292,13	347,63

For Harley Davidson Dyna Switchback, (FLD) 2010-2016

Sissy Bar made from tube with pad and carrier		6107 RG HD Dyna Switchback	Piece	236,31	281,21
Mounting Bar for additional Spotlights		6108 LH HD Dyna Switchback	Piece	69,36	82,54



6107 RG HD Dyna Switchback



6108 LH HD Dyna Switchback

Article:	Fits for:	Order No.:		EUR without Tax	EUR incl. 19% Tax
For Harley Davidson Softail (Twin Cam) Fat Boy (FLSTF/FLSTFI) 2000-2006					
Rearrack		7969 RR HD Softail FLST	Piece	130,66	155,49
Baggage Holder		7970 P HD Softail	Pair	95,04	113,10
For Harley Davidson Softail (Twin Cam 96B) Fat Boy (FLSTF/FLSTFI) 2007-2011 and 2012-2017					
Rearrack		7859 RR HD Softail FLST Bj. 07	Piece	130,66	155,49
Dto., black		7860 RR HD Softail FLST Bj. 07, schw.	Piece	130,66	155,49
Baggage Holder		7970 P HD Softail	Pair	95,04	113,10
Driver Sissy Bar with pad and Carrier	2007-2011	7861 FRG HD Softail FLSTF Bj. 07	Piece	292,13	347,63
Driver Sissy Bar with pad and Carrier	2012-2017	7849 FRG HD Softail FLSTF Bj. 12	Piece	292,13	347,63
For Harley Davidson Softail with Bobtail Fender (Twin Cam 96B), (FXSTB/07) Night Train 2007-2009 and (FLSTSB) Cross Bones 2008-2011					
Baggage Holder		7970 P HD Softail	Pair	95,04	113,10
For Harley Davidson Softail Slim, (FLS) 2012-2017 and Softail Blackline, (FXS) 2011-2013					
Rearrack, black		6047 RR HD Softail Blackline schwarz	Piece	107,24	127,62
Solo Rack from sheet metal, black		6049 BRB HD Softail Blackline schw.	Piece	127,12	151,27
Driver Sissy Bar with pad and Carrier, black		6051 FRG HD Softail Blackline schw.	Piece	292,13	347,63
For Harley Davidson Breakout (FXSB) 2013-2017					
Protection Guard one piece from tube 38 mm, black shiny		6189 DGX HD Breakout, schwarz	Piece	267,73	318,60
Baggage Holder, black shiny		6191 P HD Breakout, schwarz	Pair	95,04	113,10
Rearrack		6192 RR HD Breakout	Piece	130,66	155,49
Dto., black shiny		6193 RR HD Breakout, schwarz	Piece	130,66	155,49
Driver Sissy Bar with pad and Carrier, black shiny		6195 FRG HD Breakout, schwarz	Piece	292,13	347,63
Sissy Bar made from tube with pad and carrier		6196 RG HD Breakout	Piece	236,31	281,21
Dto., black shiny		6197 RG HD Breakout, schwarz	Piece	236,31	281,21
Solo-Rack Ø 16, curved., black shiny		6199 BR HD Breakout, schwarz	Piece	127,12	151,27



6189 DGX HD Breakout, schwarz



6191 P HD Breakout, schwarz



6192 RR HD Breakout



6195 FRG HD Breakout, schwarz



6196 RG HD Breakout



6199 BR HD Breakout, schwarz

Article:	Fits for:	Order No.:		EUR without Tax	EUR incl. 19% Tax
For Harley Davidson Softail Deluxe (Milwaukee-Eight 107/114), (FLDE) 2018-					
Protection Guard one piece from tube 38 mm black		6222 DGX HD Softail M8 FLHC, schw.	Piece	267,73	318,60
Baggage Holder		6234 P HD Softail M8 FLDE	Pair	95,04	113,10
Solo-Rack Ø 16		6235 BR HD Softail M8 FLDE	Piece	127,12	151,27
Driver Sissy Bar with big rounded pad and carrier		6236 FRG HD Softail M8 FLDE	Piece	305,98	364,12
Together with a solo seat fits also:					
Rearrack		6224 RR HD Softail M8 FLHC	Piece	130,66	155,49
(The Rearrack can not be combined with the Solo-Racks Sissy Bar made from tube with pad and carrier		6225 RG HD Softail M8 FLHC	Piece	236,31	281,21
If the rear nut for fastening the solo seat on the fender is mounted fits also:					
Solo-Rack Ø 16		6223 BR HD Softail M8 FLHC	Piece	127,12	151,27



6222 DGX HD Softail M8 FLHC, schwarz



6234 P HD Softail M8 FLDE



6235 BR HD Softail M8 FLDE



6236 FRG HD Softail M8 FLDE



6224 RR HD Softail M8 FLHC



6225 RG HD Softail M8 FLHC



6223 BR HD Softail M8 FLHC

**For Harley Davidson Softail Fat Boy (Milwaukee-Eight 107/114), (FLFB) 2018-
and Breakout (Milwaukee-Eight 107/114), (FXBR) 2018-**

Protection Guard one piece from tube 38 mm, black		6222 DGX HD Softail M8 FLHC, schw.	Piece	267,73	318,60
Solo-Rack Ø 16		6229 BR HD Softail M8 FLFB	Piece	127,12	151,27
Rearrack		6230 RR HD Softail M8 FLFB	Piece	130,66	155,49
Baggage Holder		6231 P HD Softail M8 FLFB	Pair	95,04	113,10
Sissy Bar made from tube with pad and carrier		6232 RG HD Softail M8 FLFB	Piece	236,31	281,21
Driver Sissy Bar with big rounded pad and carrier		6233 FRG HD Softail M8 FLFB	Piece	305,98	364,12



6222 DGX HD Softail M8 FLHC, schwarz



6229 BR HD Softail M8 FLFB



6230 RR HD Softail M8 FLFB



6231 P HD Softail M8 FLFB



6232 RG HD Softail M8 FLFB



6233 FRG HD Softail M8 FLFB

Article:	Fits for:	Order No.:		EUR without Tax	EUR incl. 19% Tax
For Harley Davidson Softail Heritage Classic (Milwaukee-Eight 107/114), (FLHC) 2018-					
Protection Guard one piece from tube 38 mm., black		6222 DGX HD Softail M8 FLHC, schw.	Piece	267,73	318,60
Solo-Rack Ø 16		6223 BR HD Softail M8 FLHC	Piece	127,12	151,27
Rearrack		6224 RR HD Softail M8 FLHC	Piece	130,66	155,49
Sissy Bar made from tube with pad and carrier		6225 RG HD Softail M8 FLHC	Piece	236,31	281,21
Driver Sissy Bar with big rounded pad and carrier		6226 FRG HD Softail M8 FLHC	Piece	305,98	364,12



6222 DGX HD Softail M8 FLHC, schwarz



6223 BR HD Softail M8 FLHC



6224 RR HD Softail M8 FLHC



6225 RG HD Softail M8 FLHC



6226 FRG HD Softail M8 FLHC

For Harley Davidson Softail Sport Glide (Milwaukee-Eight 107/114), (FLSB) 2018-

Protection Guard one piece from tube 38 mm, black		6222 DGX HD Softail M8 FLHC, schw.	Piece	267,73	318,60
Rear-Rack Ø 16, low and wide form		6260 RR2 HD Softail Sport Glide	Piece	142,25	169,28
Dto., black		6261 RR2 HD Softail Sport Glide, schwarz	Piece	142,25	169,28
Mounting Bar for additional Spotlights		6262 LH HD Softail Sport Glide	Piece	69,36	82,54
Dto., black		6263 LH HD Softail Sport Glide, schwarz	Piece	69,36	82,54
Sissy Bar made from tube with pad and carrier, black		6265 RG HD Softail Sport Glide; schwarz	Piece	236,31	281,21
Rear Protection Guard for Cases		6266 H HD Softail Sport Glide	Pair	122,61	145,91
Dto., black		6267 H HD Softail Sport Glide, schwarz	Pair	122,61	145,91



6222 DGX HD Softail M8 FLHC, schwarz



6260 RR2 HD Softail Sport Glide



6262 LH HD Softail Sport Glide

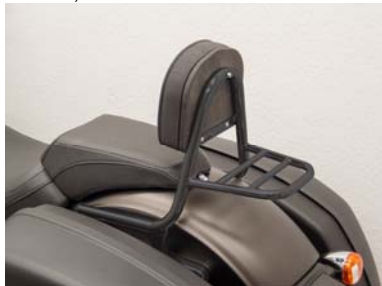

6265 RG HD Softail Sport Glide, schwarz



6266 H HD Softail Sport Glide

Article:	Fits for:	Order No.:		EUR without Tax	EUR incl. 19% Tax
For Harley Davidson Softail Street Bob (Milwaukee-Eight 107/114), (FXBB) 2018-					
Protection Guard one piece from tube 38 mm, black (6222 fit also in combination with forward mounted footrests)		6222 DGX HD Softail M8 FLHC, schw.	Piece	267,73	318,60
Protection Guard one piece from tube 38 mm, conical form Dto., black		6244 DGX4 HD Softail Street Bob	Piece	267,73	318,60
Protection Guard from tube 32 mm, low form Dto., black		6245 DGX4 HD Softail Street Bob, schwarz	Piece	267,73	318,60
Protection Guard from tube 32 mm Dto., black		6246 DG2 HD Softail Street Bob	Piece	234,67	279,26
Baggage Holder Dto., black		6247 DG2 HD Softail Street Bob, schwarz	Piece	234,67	279,26
Driver Sissy Bar with pad and Carrier Dto., black		6248 DG HD Softail Street Bob	Piece	234,67	279,26
Solo-Rack Ø 16, curved, black		6249 DG HD Softail Street Bob, schwarz	Piece	234,67	279,26
Solo-Rack Ø 16, wide form, black		6250 P HD Softail Street Bob	Pair	95,04	113,10
		6251 P HD Softail Street Bob, schwarz	Pair	95,04	113,10
		6252 FRG HD Softail Street Bob	Piece	292,13	347,63
		6253 FRG HD Softail Street Bob, schwarz	Piece	292,13	347,63
		6255 BR HD Softail Street Bob, schwarz	Piece	127,12	151,27
		6257 BR2 HD Softail Street Bob, schwarz	Piece	142,25	169,28



6222 DGX HD Softail M8 FLHC, schwarz



6244 DGX4 HD Softail Street Bob



6246 DG2 HD Softail Street Bob



6246 von vorne



6248 DG HD Softail Street Bob



6250 P HD Softail Street Bob

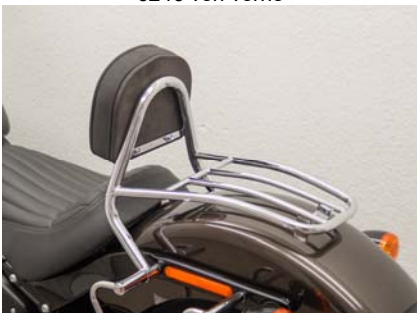

6252 FRG HD Softail Street Bob



6250 + 6252



6255 BR HD Softail Street Bob, schwarz



6257 BR2 HD Softail Street Bob, schwarz

Article:	Fits for:	Order No.:		EUR without Tax	EUR incl. 19% Tax
For Harley Davidson Softail Low Rider (Milwaukee-Eight 107/114), (FXLR) 2018-					
Protection Guard one piece from tube 38 mm; black (6222 fit also in combination with forward mounted footrests)		6222 DGX HD Softail M8 FLHC, schw.	Piece	267,73	318,60
Protection Guard one piece from tube 38 mm, conical form Dto., black		6244 DGX4 HD Softail Street Bob	Piece	267,73	318,60
Protection Guard from tube 32 mm, low form Dto., black		6245 DGX4 HD Softail Street Bob, schwarz	Piece	267,73	318,60
Protection Guard from tube 32 mm Dto., black		6246 DG2 HD Softail Street Bob	Piece	234,67	279,26
Baggage Holder Dto., black		6247 DG2 HD Softail Street Bob, schwarz	Piece	234,67	279,26
Rearrack Dto., black		6248 DG HD Softail Street Bob	Piece	234,67	279,26
Sissy Bar made from tube with pad and carrier Dto., black		6249 DG HD Softail Street Bob, schwarz	Piece	234,67	279,26
Seat Border Dto., black		6268 P HD Softail Low Rider	Pair	95,04	113,10
		6269 P HD Softail Low Rider, schwarz	Pair	95,04	113,10
		6270 RR HD Softail Low Rider	Piece	130,66	155,49
		6271 RR HD Softail Low Rider, schwarz	Piece	130,66	155,49
		6272 RG HD Softail Low Rider	Piece	236,31	281,21
		6273 RG HD Softail Low Rider; schwarz	Piece	236,31	281,21
		6274 SU HD Softail Low Rider	Pair	96,01	114,25
		6275 SU HD Softail Low Rider, schwarz	Pair	96,01	114,25



6222 DGX HD Softail M8 FLHC, schwarz



6244 DGX4 HD Softail Street Bob



6246 DG2 HD Softail Street Bob



6248 DG HD Softail Street Bob



6268 P HD Softail Low Rider



6270 RR HD Softail Low Rider



6272 RG HD Softail Low Rider



6274 SU HD Softail Low Rider

Article:	Fits for:	Order No.:		EUR without Tax	EUR incl. 19% Tax
For Harley Davidson V-Rod, (VRSCA/VRSCB/VRSCD) 2001-2007 and V-Rod, (VRSCAW/VRSCDX) (Night Rod) 2008-2011					
Protection Guard one piece from tube 38 mm		7155 DGX HD V-Rod	Piece	267,73	318,60
Sissy Bar with pad	VRSCAW, VRSCDX	7158 R2 HD V-Rod VRSCAW	Piece	232,41	276,57
For Harley Davidson Night Rod Special, (VRSCDX/12) 2012-2017					
Rearrack		7154 RR HD Night Rod Special Bj. 12	Piece	130,66	155,49
For Harley Davidson V-Rod Muscle (VRSCF) 2009-2011					
Protection Guard one piece from tube 38 mm		7171 DGX HD V-Rod Muscle	Piece	267,73	318,60
Baggage Holder		7172 P HD V-Rod Muscle	Pair	95,04	113,10

Honda

Article:	Fits for:	Order No.:		EUR without Tax	EUR incl. 19% Tax
For Honda Rebel CA 125, (JC24/26) 1995-2001 and CMX 250 C, (MC13) 1996-1996 and CMX 250, (MC32) 1997-2001 Baggage Holder		7301 P HO Rebel 125/250	Pair	95,04	113,10
For Honda VT 125 Shadow, (JC29/31) 1999-2007 Protection Guard Baggage Holder Sissy Bar made from tube with pad and carrier Mounting Bar for additional Spotlights		7391 D HO VT 125 Shadow 7383 P HO VT 125 Shadow 7385 RG HO VT 125 Shadow 7392 LH HO VT 125 Shadow	Piece Pair Piece Piece	133,90 95,04 236,31 69,36	159,34 113,10 281,21 82,54
For Honda CRF 300 L (ND16) 2021- Protection Guard, black		7313 ES HO CRF 300 L	Piece	161,16	191,78



7313 ES HO CRF 300 L

**For Honda Silver Wing SWT 400, (NFO3) 2009-2016
and SWT 600, (SWT600) 2007-2016**

Topcase Carrier for Givi/Kappa (Monokey) Cases	7810 TT HO SWT 400/600	Piece	165,31	196,72
Sidecase Carrier for Givi/Kappa (Monokey) Cruiser Cases	7811 ST HO SWT 400/600	Pair	217,04	258,28
For Honda CB 500, (PC26/32) (PC27/33) 1993-2004 Engine Protection Guard, solid	7328 MS HO CB 500	Pair	120,05	142,86

**For Honda CB 500 F, (PC45) 2013-2015
and CB 500 X, (PC46) 2013-2016**

Protection Guard, black	7937 SE HO CB 500 F	Pair	122,31	145,55
-------------------------	---------------------	------	--------	--------



7937 SE HO CB 500 F

Article:	Fits for:	Order No.:		EUR without Tax	EUR incl. 19% Tax
For Honda CMX 500 Rebel (PC56A) 2017-					
Protection Guard, black		7246 SE HO CMX 500 Rebel	Pair	193,92	230,76
Baggage Holder, black		7247 P HO CMX 500 Rebel	Pair	95,04	113,10
Solo-Rack Ø 16, black		7249 BR HO CMX 500 Rebel	Piece	127,12	151,27
Sissy Bar made from tube with pad and carrier, black		7250 RG HO CMX 500 Rebel	Piece	236,31	281,21
Driver Sissy Bar with pad and Carrier, black		7251 FRG HO CMX 500 Rebel	Piece	292,13	347,63
Driver Sissy Bar with pad, black		7252 FR HO CMX 500 Rebel	Piece	119,44	142,13
Mounting Bar for additional Spotlights, black		7253 LH HO CMX 500 Rebel	Piece	69,36	82,54



7246 SE HO CMX 500 Rebel



7247 P HO CMX 500 Rebel



7249 BR HO CMX 500 Rebel



7250 RG HO CMX 500 Rebel



7251 FRG HO CMX 500 Rebel



7252 FR HO CMX 500 Rebel



7253 LH HO CMX 500 Rebel

For Honda CX 500/650 (also E + C) + GL 500/650 with aluminium cooler cover

Protection Guard		7234 SE HO CX/GL 500/650	Pair	105,96	126,09
------------------	--	--------------------------	------	--------	--------

For Honda CB 600 F Hornet, (PC36) 2000-2006

Protection Guard, black		7363 SE HO Hornet 600, schwarz	Pair	105,96	126,09
-------------------------	--	--------------------------------	------	--------	--------

**For Honda CBF 600, (PC38) 2004-2007
and Honda CBF 600 S, (PC38/S) 2004-2007**

Engine Protection Guard, solid, black		7938 MS HO CBF 600 schwarz	Pair	120,05	142,86
---------------------------------------	--	----------------------------	------	--------	--------

For Honda CBF 600, (PC43) 2008-2012

Protection Guard 2 pcs., black		7374 D HO CBF 600 Bj. 08	Pair	161,16	191,78
--------------------------------	--	--------------------------	------	--------	--------

For Honda CB 650 F, (RC97) 2017-

Protection Guard, black		7359 SE HO CB 650 F	Pair	161,16	191,78
Baggage Holder, black		7361 P HO CB 650 F	Pair	95,04	113,10
Luggage Carrier, black		7360 G HO CB 650 F	Piece	150,91	179,58

For Honda XL 650 V Transalp, (RD10/11) 2000-2007

Enduro Protection Guard, black		7368 ES HO XL 650 V Transalp	Pair	234,06	278,53
--------------------------------	--	------------------------------	------	--------	--------

For Honda CTX 700 N, (RC68) 2014-2016

Protection Guard, black		6138 D HO CTX 700 N	Pair	208,38	247,97
Baggage Holder, black		6139 P HO CTX 700 N	Pair	95,04	113,10
Luggage Carrier, black		6140 G HO CTX 700 N	Piece	150,91	179,58
Sissy Bar made from tube with pad and carrier, black		6141 RG HO CTX 700 N	Piece	236,31	281,21



6138 D HO CTX 700 N



6139+40 P+G HO CTX 700 N

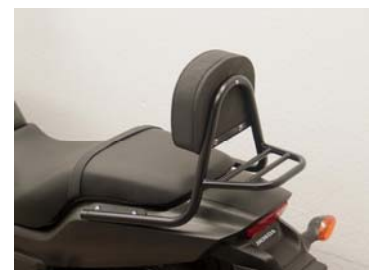

6141 RG HO CTX 700 N

Article:	Fits for:	Order No.:		EUR without Tax	EUR incl. 19% Tax
For Honda NC 700 X, (RC63) 2012-2013 and NC 750 X, (RC72) 2014-2015, (also DCT) Enduro Protection Guard, black	NC 700/750 X	7293 ES HO NC 700 X	Piece	193,92	230,76



7293 ES HO NC 700 X

**For Honda CB 750 K, (RC01) 1979-1981
and CB 750 F, (RC04) 1980-1984
and CB 900 F – FB, (SC01) 1979-1981**
Engine Protection Guard

7373 M HO 78 Pair 105,96 126,09

For Honda CB 750 Seven Fifty, (RC42) 1992-2003
Engine Protection Guard, solid

7382 MS HO CB 750 Seven Fifty Pair 120,05 142,86

**For Honda NC 750 X/XD, (RC90) (also DCT) 2016-2020
For Honda NC 750 S/SD, (RC88) (also DCT) 2016-2020**
Enduro Protection Guard, black NC 750 X/XD
(Only the guard 7283 or 7284 can be mounted on the NC 750 X/XD)
Protection Guard, black
Luggage Carrier, black

7283 ES HO NC 750 X/XD Piece 193,92 230,76
7284 SE HO NC 750 X/XD Pair 161,16 191,78
7285 G HO NC 750 X/XD Piece 150,91 179,58



7283 ES HO NC 750 X/XD



7284 SE HO NC 750 X/XD



7285 G HO NC 750 X/XD

For Honda VT 750 C2, (RC44) 1997-2001

Protection Guard, big design 7362 DG HO VT 750 C2 Piece 208,38 247,97
Baggage Holder 7357 P HO VT 750 C2 Pair 95,04 113,10
Mounting Bar for additional Spotlights 7379 LH HO VT 750 C2 Piece 69,36 82,54

**For Honda VT 750 C4, CS (RC50) 2004-2007
and VT 750 C8 (RC50/08) 2008-2009 and VT 750 C10 (RC50/10) (also ABS) 2010-**

Protection Guard, extra big design from tube 38 mm 7276 DGX HO VT 750 C ABS Piece 267,73 318,60
Dto., black 7277 DGX HO VT 750 C ABS, schw. Piece 267,73 318,60
Baggage Holder 7377 P HO VT 750 C4 Pair 95,04 113,10
Mounting Bar for additional Spotlights 7400 LH HO VT 750 C4 Piece 69,36 82,54
Sissy Bar made from tube with pad and carrier 7390 RG HO VT 750 CS Piece 236,31 281,21

**For Honda Shadow VT 750 C Black Spirit, (RC53BS) 2010-2011
and VT 750 C Spirit, (RC53) 2007-2009 and (RC53/10) 2010-2013**

Protection Guard, extra big design from tube 38 mm 7276 DGX HO VT 750 C ABS Piece 267,73 318,60
Dto., black 7277 DGX HO VT 750 C ABS, schw. Piece 267,73 318,60
Baggage Holder 7278 P HO VT 750 C7 Spirit Pair 95,04 113,10
Dto., black 7642 P HO VT 750 C7 Spirit, schw. Pair 95,04 113,10
Rearrack, black 7643 RR HO VT 750 C7 Spirit, schw. Piece 130,66 155,49
Sissy Bar made from tube with pad and carrier 7282 RG HO VT 750 C7 Spirit Piece 236,31 281,21
Dto., black 7647 RG HO VT 750 C7 Spirit, schw. Piece 236,31 281,21
Mounting Bar for additional Spotlights VT 750 C Black Spirit (RC50BS) 7400 LH HO VT 750 C4 Piece 69,36 82,54

For Honda VT 750 S (Chain), (RC58) 2010-2011

Protection Guard, big design from tube 30 mm 7302 DG HO VT 750 S Piece 234,67 279,26
Baggage Holder 7304 P HO VT 750 S Pair 95,04 113,10
Sissy Bar made from tube with pad and carrier 7316 RG HO VT 750 S Piece 236,31 281,21

Article:	Fits for:	Order No.:		EUR without Tax	EUR incl. 19% Tax
For Honda X-ADV 750, (RC95) 2017-2020					
Protection Guard, below, black		7323 SE HO X-ADV 750	Pair	193,92	230,76
Luggage Carrier, black		7324 G HO X-ADV 750	Piece	150,91	179,58
Sidecase Carrier „flex“, black		7325 K HO X-ADV 750	Pair	255,90	304,52



7323 SE HO X-ADV 750



7324 G HO X-ADV 750



7325 K HO X-ADV 750

For Honda XRV 750 Africa Twin, (RD07) 1996-2003

Enduro Protection Guard, black

7329 ES HO XRV 750 Africa Twin	Pair	234,06	278,53
--------------------------------	------	--------	--------

For Honda CRF 1000 L Africa Twin (also DCT) (SD04) 2015-2016 and (SD06) 2017-2019

Enduro Protection Guard above, black
Protection Guard, below, black

6203 ES HO CRF 1000 L Africa Twin	Piece	232,47	276,64
6204 SE HO CRF 1000 L Africa Twin	Pair	193,92	230,76



6203+04 ES+SE HO CRF 1000 L AT



6203 ES HO CRF 1000 L Africa Twin



6204 SE HO CRF 1000 L Africa Twin



6205 T HO CRF 1000 L Africa Twin

Topcase Carrier „flex“, black

from sheet metal with 16 mm tube border and handgrip to screw on (Maximum load 5 kg)

for Givi/Kappa (Monokey) Topcase (inclusive lock kit) (Not for Trekker Dolomiti)

for Hepco & Becker Topcase Junior, Journey, Gobi and Explorer (lock kit belongs to the case)

for SW-Motech Topcase Trax and Trax Evo (in combination with original SW-Motech lock kit)

6205 T HO CRF 1000 L Africa Twin	Piece	180,13	214,35
----------------------------------	-------	--------	--------

Cover for regulator box, stainless steel

Foot enlargement for sidestand, Stainless steel

High adjustment for the windscreen 30 – 80 mm black

Squirt protection for the Topcase, Stainless steel black

Device holder low with 18 mm tube

Device holder high with 18 mm tube

6209 Gehäuse Regler CRF 1000 L	Piece	49,78	59,24
--------------------------------	-------	-------	-------

6210 Ständervergrößerung CRF1000L	Piece	45,93	54,66
-----------------------------------	-------	-------	-------

6211 Scheibenverstellung CRF 1000 L	Piece	98,88	117,67
-------------------------------------	-------	-------	--------

6212 Spritzschutz CRF 1000 L	Piece	34,04	40,51
------------------------------	-------	-------	-------

6213 Gerätehalter niedrig	Piece	58,74	69,90
---------------------------	-------	-------	-------

6214 Gerätehalter, hoch	Piece	61,31	72,96
-------------------------	-------	-------	-------



6209 Gehäuse Regler CRF 1000 L



6210 Ständervergrößerung CRF1000L



6211 Scheibenverstellung CRF 1000 L



6211 Scheibenverstellung CRF 1000 L



6212 Spritzschutz CRF 1000 L



6213 Gerätehalter niedrig



6214 Gerätehalter hoch

For Honda Varadero XL 1000 V, (SD02) 2002

Enduro Protection Guard, black

XL 1000 V bis Bj. 02

7330 ES HO XL 1000V Varadero	Pair	232,47	276,64
------------------------------	------	--------	--------

Article:	Fits for:	Order No.:		EUR without Tax	EUR incl. 19% Tax
For Honda CB 1100 (Cast Wheels), (SC65) 2013-2014					
For Honda CB 1100 EX (Spoke Wheels), (SC65) 2014-2016					
Engine Protection Guard, solid		6113 MS HO CB 1100	Pair	120,05	142,86
Baggage Holder		6115 P HO CB 1100	Pair	95,04	113,10
Seat Border		6116 SU HO CB 1100	Piece	96,01	114,25
Luggage Carrier	CB 1100 (Cast Wheels)	6114 G HO CB 1100	Piece	150,91	179,58
Luggage Carrier	CB 1100 EX (Spoke Wheels)	6144 G HO CB 1100 EX	Piece	150,91	179,58
For Honda CB 1100 EX (SC78A) 2017-2020					
and CB 1100 RS (SC78B) 2017-2020					
Engine Protection Guard, solid		6113 MS HO CB 1100	Pair	120,05	142,86
Luggage Carrier		6200 G HO CB 1100 RS	Piece	150,91	179,58
Baggage Holder		6201 P HO CB 1100 RS	Pair	95,04	113,10



6113 MS HO CB 1100



6200 G HO CB 1100 RS



6201 P HO CB 1100 RS

For Honda VT 1100 C2, (SC32) 1995-1997
and VT 1100 C3, (SC39) 1998-2001

Mounting Bar for additional Spotlights	VT 1100 C2 (SC32)	7341 LH HO VT 1100 C2 ACE	Piece	69,36	82,54
Mounting Bar for additional Spotlights	VT 1100 C3 (SC39)	7379 LH HO VT 750 C2	Piece	69,36	82,54

For Honda CB 1300, (SC54) 2003-2007

Engine Protection Guard, solid		7298 MS HO CB 1300	Pair	120,05	142,86
Dto., black		7299 MS HO CB 1300, schwarz	Pair	120,05	142,86
Luggage Carrier, black		7300 G HO CB 1300	Piece	150,91	179,58

For Honda VTX 1300, (SC52) 2003-2007

Protection Guard, extra big design from tube 38 mm		7289 DGX HO VTX 1300	Piece	267,73	318,60
Mounting Bar for additional Spotlights		7286 LH HO VTX 1300	Piece	69,36	82,54

For Honda VT 1300 CX (Fury), (SC61) 2010-2012

Protection Guard, extra big design from tube 38 mm		7768 DGX HO VT 1300 CX	Piece	267,73	318,60
Baggage Holder		7769 P HO VT 1300 CX	Pair	95,04	113,10
Radiator Cover from sheet metal		7771 KA HO VT 1300 CX	Piece	83,45	99,31
Sissy Bar made from tube with pad and carrier		7772 RG HO VT 1300 CX	Piece	236,31	281,21

For Honda F6C (Valkyrie), (SC34) 1996-2001

Protection Guard 2 pcs., big design from tube 30 mm, with cylinder head protection		7393 DG HO F6C	Pair	251,69	299,51
Rearrack		7394 RR HO F6C	Piece	130,66	155,49
Mounting Bar for additional Spotlights		7398 LH HO F6C	Piece	69,36	82,54

For Honda VTX 1800, (SC46A) 2001-2006

Protection Guard, big design from tube 30 mm		7310 DG HO VTX 1800	Piece	234,67	279,26
Baggage Holder		7311 P HO VTX 1800	Pair	95,04	113,10
Mounting Bar for additional Spotlights		7315 LH HO VTX 1800	Piece	69,36	82,54

Kawasaki

Article:	Fits for:	Order No.:		EUR without Tax	EUR incl. 19% Tax
For Kawasaki ER 5 Twister, (ER500A/B-D) 2001-2006					
Engine Protection Guard, solid		7629 MS KA ER 5	Pair	120,05	142,86
For Kawasaki Zephyr 550/750, (ZR550B)/(ZR750C) 1991-1999 and ZR-7, (ZR750F) 1999-2003					
Engine Protection Guard, solid		7628 MS KA Zephyr 550/750	Pair	120,05	142,86
Engine Protection Guard, solid, black		7626 MS KA ZR-7	Pair	120,05	142,86
Luggage Carrier, black	ZR-7	7627 G KA ZR-7	Piece	150,91	179,58
For Kawasaki ER 6n, (ER650A) 2005-2008					
Engine Protection Guard, solid, black		7674 SE KA ER 6n	Pair	161,16	191,78
For Kawasaki ER 6 n/f, (ER650C/EX650C) 2009-2011					
Engine Protection Guard, solid, black		7671 SE KA ER 6n Bj. 09	Pair	161,16	191,78
For Kawasaki Versys, (LE650C) 2010-2014					
Engine Protection Guard, solid, black		7700 SE KA Versys Bj. 10	Pair	161,16	191,78
For Kawasaki Versys 650, (LE650E) 2015-2016					
Engine Protection Guard, solid, black		7648 SE KA Versys Bj. 15	Pair	161,16	191,78
For Kawasaki Vulcan S (EN650A) 2015-2020 and (EN650J) 2021-					
Protection Guard 2 pcs., black		7683 D KA Vulcan S	Pair	208,38	247,97
Baggage Holder, black		7684 P KA Vulcan S	Pair	95,04	113,10
Rearrack, black		7685 RR KA Vulcan S	Piece	130,66	155,49
Sissy Bar made from tube with pad and carrier, black		7686 RG KA Vulcan S	Piece	236,31	281,21
Driver Sissy Bar with pad and Carrier, black		7687 FRG KA Vulcan S	Piece	292,13	347,63



7683 D KA Vulcan S



7684 P KA Vulcan S



7685 RR KA Vulcan S



7686 RG KA Vulcan S



7687 FRG KA Vulcan S

For Kawasaki W 650, (EJ650A) 1999-2006 und W 800, (EJ800A) 2011-2016

Protection Guard		6021 D KA W 800	Piece	161,16	191,78
Baggage Holder		6022 P KA W 800	Pair	95,04	113,10
Luggage Carrier		6023 G KA W 800	Piece	150,91	179,58
Adapter for „Deco Cover Injection system left“	W 800	6026 ZBA KA W 800	Piece	34,34	40,86
(for mounting of „Deco Cover Injection system left“ on the right side)					
Deco Cover Injection system left	W 800	6027 ZB1 KA W 800	Piece	43,68	51,98
Deco Cover Set, below	W 800	6029 ZB3 KA W 800	Pair	66,80	79,49

Article:	Fits for:	Order No.:		EUR without Tax	EUR incl. 19% Tax
For Kawasaki Z 650 (ER650) 2017-2019 and Ninja 650 (EX650) 2017-					
Engine Protection Guard, black	Z 650	7701 SE KA Z 650 Bj. 17	Pair	161,16	191,78
Baggage Holder, black		7702 P KA Z 650 Bj. 17	Pair	95,04	113,10
Luggage Carrier, black		7704 G KA Z 650 Bj. 17	Piece	150,91	179,58



7701 SE KA Z 650 Bj. 17



7702 P KA Z 650 Bj. 17



7704 G KA Z 650 Bj. 17

**For Kawasaki Z 750, (ZR750J) 2004-2006
and Z 1000, (ZR1000A) 2003-2006**

Engine Protection Guard, solid, black

7673 MS KA Z 750/1000	Pair	120,05	142,86
-----------------------	------	--------	--------

**For Kawasaki VN 800, (VN800-A) 1995-2000
and VN 800 Classic, (VN800-B) 1996-2005**

Protection Guard 2 pcs.

Fender Guard, front

Mounting Bar for additional Spotlights

VN 800 Classic

VN 800 Classic

7667 D KA VN 800	Pair	208,38	247,97
7664 RL KA VN 800 Classic Bj. 00	Piece	134,20	159,70
7706 LH KA VN 1500 Mean Streak	Piece	69,36	82,54

For Kawasaki VN 900 Classic, (VN900B) 2006-2017

Protection Guard, extra big design from tube 38 mm

Mounting Bar for additional Spotlights

7615 DGX KA VN 900 Classic	Piece	267,73	318,60
7619 LH KA VN 900 Classic	Piece	69,36	82,54

For Kawasaki VN 900 Custom, (VN900C) 2007-2017

Protection Guard, extra big design from tube 38 mm, black

Baggage Holder, black

Rearrack, black

Sissy Bar made from tube with pad and carrier, black

VN 900 Classic, VN 900 Custom

6030 DGX KA VN 900 Custom	Piece	267,73	318,60
7614 P KA VN 900 Classic, schwarz	Pair	95,04	113,10
6031 RR KA VN 900 Custom	Piece	130,66	155,49
6032 RG KA VN 900 Custom	Piece	236,31	281,21

For Kawasaki Z 900 (ZR90) 2017-

Luggage Carrier, black

7712 G KA Z 900 Bj. 17	Piece	150,91	179,58
------------------------	-------	--------	--------

For Kawasaki Z 900 RS (ZR900C) 2018-2020

Protection Guard, black

Luggage Carrier, chrom (inclusive reflector transfer)

Baggage Holder, chrom (inclusive reflector transfer)

Seat Border, chrome

Handhold, chrome (fits left and right)

Sheet metal to move the rear lateral reflectors

7255 SE KA Z 900 RS	Pair	193,92	230,76
7256 G KA Z 900 RS	Piece	150,91	179,58
7257 P KA Z 900 RS	Pair	95,04	113,10
7258 SU KA Z 900 RS	Piece	96,01	114,25
7259 HG KA Z 900 RS	Piece	37,58	44,72
7260 Reflektorhalter KA Z 900 RS	Piece	24,10	28,68



7255 SE KA Z 900 RS



7256 G KA Z 900 RS



7257 P KA Z 900 RS



7258 SU KA Z 900 RS



7259 HG KA Z 900 RS



7260 Reflektorhalter KA Z 900 RS

Article:	Fits for:	Order No.:		EUR without Tax	EUR incl. 19% Tax
For Kawasaki ZRX 1100, (ZRT10C) 1997-2006 and ZRX 1200 S/R, (ZRT20A/B) 2001-2007					
Engine Protection Guard, solid, black		7630 MS KA ZRX 1100/1200, schw.	Pair	120,05	142,86
(By ZRX 1100 the engine guards will only fit by models, where on the left side the holder of the cooler hose is screwed on the frame. If the holder of the hose is welded on the frame the engine guards will not fit.)					
For Kawasaki VN 1500 Classic, (VNT50D) 1996-2002					
Mounting Bar for additional Spotlights		7706 LH KA VN 1500 Mean Streak	Piece	69,36	82,54
For Kawasaki VN 1500 Mean Streak, (VNT50P) 2002-2003 and VN 1600 Mean Streak, (VNT60B) 2004-2008					
Protection Guard, big design from tube 30 mm		7703 DG KA VN 1500 Mean Streak	Piece	234,67	279,26
Rearrack		7705 RR KA VN 1500 Mean Streak	Piece	130,66	155,49
Mounting Bar for additional Spotlights		7706 LH KA VN 1500 Mean Streak	Piece	69,36	82,54
For Kawasaki VN 1600 Classic, (VNT60A) 2003-2008 (This parts will not fit the Classic Tourer)					
Protection Guard, big design from tube 30 mm		7710 DG KA VN 1600 Classic	Piece	234,67	279,26
Baggage Holder		7711 P KA VN 1600 Classic	Pair	95,04	113,10
For Kawasaki VN 1700 Classic, (VNT70E) 2009-2014					
Protection Guard, extra big design from tube 38 mm		6010 DGX KA VN 1700 Classic	Piece	267,73	318,60
Baggage Holder		6011 P KA VN 1700 Classic	Pair	95,04	113,10
Fender Guard, front		6014 RL KA VN 1700 Classic	Piece	134,20	159,70
Mounting Bar for additional Spotlights		6019 LH KA VN 1700 Classic	Piece	69,36	82,54

Piaggio / Vespa

Article:	Fits for:	Order No.:		EUR without Tax	EUR incl. 19% Tax
For Piaggio MP3 LT 500 i.e., New ABS-ASR Sport/Business, (M861) 2014-2016					
Protection Guard, lateral		6168 SS PI MP3 LT 500 i.e. New ABS-ASR	Pair	158,30	188,38
Topcase Carrier „flex“, black, with chrome border		6170 T PI MP3 LT 500 i.e. New ABS-ASR	Piece	180,13	214,35
Sidescase Carrier „flex“		6171 K PI MP3 LT 500 i.e. New ABS-ASR	Pair	255,90	304,52



6168 SS PI MP3 LT 500 i.e. New ABS-ASR



6170 T PI MP3 LT 500 i.e. New ABS-ASR



6171 K PI MP3 LT 500 i.e. New ABS-ASR

Suzuki

Article:	Fits for:	Order No.:		EUR without Tax	EUR incl. 19% Tax
For Suzuki GZ 125 Marauder, (AP) 1998-2001 and GZ 250 Marauder, (AR) 1999-2001					
Protection Guard	GZ 125	7448 D SU GZ 125 Marauder	Piece	133,90	159,34
Baggage Holder		7449 P SU GZ 125/250 Marauder	Pair	95,04	113,10
Sissy Bar made from tube with pad and carrier		7458 RG SU GZ 125/250 Marauder	Piece	236,31	281,21
For Suzuki VL 125 LC Intruder, (A4) 1999-2007					
Protection Guard		7462 D SU VL 125 LC Intruder	Piece	133,90	159,34
Sissy Bar made from tube with pad and carrier		7468 RG SU VL 125 LC Intruder	Piece	236,31	281,21
For Suzuki AN 400 Burgman, (WVCG) 2007-2009 and AN 400 Burgman Z ABS, (WVCG/10) 2010-2016					
Fender Guard front		7812 RL SU AN 400 Burgman Bj. 07	Piece	134,20	159,70
Side Case Carrier for Givi/Kappa (Monokey) Cruiser Cases		7817 ST SU AN 400 Burgman Bj. 07	Pair	217,04	258,28



7812 RL SU AN 400 Burgman Bj. 07



7817 ST SU AN 400 Burgman Bj. 07

For Suzuki GS 500 E, (GM51B) 1989-2000 and (WVBK) 2001-2007 and GS 500 F, (BK) 2004-2008					
Engine Protection Guard, solid		7432 MS SU GS 500 E	Pair	120,05	142,86
For Suzuki GSR 600, (WVB9) 2006-2011					
Engine Protection Guard, solid, black	7118	SE SU GSR 600	Pair	161,16	191,78
For Suzuki GSF 600 Bandit, (GN77B) 1995-1999 and (WVA8) 2001-2004 and GSX 750, (AE) 1998-2003					
Engine Protection Guard, solid		7429 MS SU GSF 600 Bandit	Pair	120,05	142,86
For Suzuki VS 600 Intruder, (VN51B) 1995-1997 and VS 750 Intruder, (VR51B) 1986-1991 and VS 800 Intruder, (VS52B) 1992-2000					
Protection Guard 2 pcs.		7408 D SU VS 750 Intruder	Pair	208,38	247,97
Baggage Holder		7423 P SU VS 600-1400	Pair	95,04	113,10
Mounting Bar for additional Spotlights		7402 LH SU VS 600-1400	Piece	69,36	82,54
For Suzuki AN 650 Burgman (also Executive and ABS), (WVBU/A) 2004-2012					
Side Case Carrier for Givi/Kappa (Monokey) Cruiser Cases		7847 ST SU AN 650 Burgman	Pair	217,04	258,28
For Suzuki DL 650 A V-Strom (C7) 2012-2016					
Protection Guard, black		7403 SE SU DL 650 V-Strom Bj. 12	Pair	161,16	191,78



7403 SE SU DL 650 V-Strom Bj. 12

Article:	Fits for:	Order No.:		EUR without Tax	EUR incl. 19% Tax
For Suzuki GSF 650 Bandit (Air cooled), (WVB5) 2005-2006 and GSF 650 Bandit (Water cooled), (WVCJ) 2007-2008 and (WVCZ) 2009-2012					
Engine Protection Guard, solid, black, up to 2006 (Air cooled)		7470 MS SU GSF 650 Bandit, schw.	Pair	120,05	142,86
Engine Protection Guard, solid, black, since 2007 (Water cooled)		7447 MS SU GSF 650 Bj. 07, schwarz	Pair	120,05	142,86
Luggage Carrier, black		7300 G HO CB 1300	Piece	150,91	179,58
For Suzuki M 800 Intruder, (WVB4/05) 2005-2009					
Protection Guard, big design from tube 30 mm		7841 DG SU Intruder M800	Piece	234,67	279,26
Mounting Bar for additional Spotlights		7842 LH SU Intruder M800	Piece	69,36	82,54
Rearrack		7845 RR SU Intruder M800	Piece	130,66	155,49
Baggage Holder		7846 P SU Intruder M800	Pair	95,04	113,10
For Suzuki VL 800 Volusia, (WVBM) 2001-2004 and C 800 Intruder, (WVBM/05) 2005-2008 and (WVBM/09) 2009-					
Protection Guard, big design from tube 30 mm up to 2008		7477 DG SU VL 800 Intruder LC Volusia	Piece	234,67	279,26
Protection Guard, big design from tube 30 mm since 2009		7476 DG SU C 800 Bj. 09	Piece	234,67	279,26
Baggage Holder		7478 P SU VL 800 Intruder LC Volusia	Pair	95,04	113,10
Rearrack		7479 RR SU VL 800 Intruder LC Volusia	Piece	130,66	155,49
Mounting Bar for additional Spotlights		7483 LH SU VL 800 Intruder LC Volusia	Piece	69,36	82,54
For Suzuki VZ 800 Marauder, (JS1AF) 1996-2003					
Protection Guard, big design		7409 DG SU VZ 800 Marauder	Piece	208,38	247,97
Rearrack		7413 RR SU VZ 800 Marauder	Piece	130,66	155,49
Mounting Bar for additional Spotlights		7410 LH SU VZ 800 Marauder	Piece	69,36	82,54
For Suzuki GSX 1200, (A3) 1999-2000 and GSF 1200 Bandit, (GV75A) 1996-2000, and (WVA9) 2001-2005, and (WVCB) 2006 and GSF 1250 Bandit, (WVCH) 2007-2010					
Engine Protection Guard, solid GSX 1200, GSF 1200		7426 MS SU GSF 1200 Bandit	Pair	120,05	142,86
Engine Protection Guard, solid, black, GSF 1250		7424 MS SU GSF 1250 Bandit, schwarz	Pair	120,05	142,86
Luggage Carrier, black GSF 1200 (WVCB) 2006 GSF 1250		7300 G HO CB 1300	Piece	150,91	179,58
For Suzuki GSX 1400, (WVBN) 2001-2006					
Engine Protection Guard, solid		7485 MS SU GSX 1400	Pair	120,05	142,86
Luggage Carrier		7487 G SU GSX 1400	Piece	150,91	179,58
For Suzuki VS 1400 Intruder, (VX51L) 1987-2003					
Protection Guard 2 pcs.		7425 D SU VS 1400	Pair	208,38	247,97
Baggage Holder		7423 P SU VS 600-1400	Pair	95,04	113,10
Rearrack VS 1400 (VX51L/T) since 1996 with original Sissy Bar		7407 RR SU VS 1400	Piece	130,66	155,49
Mounting Bar for additional Spotlights		7402 LH SU VS 600-1400	Piece	69,36	82,54
For Suzuki VL 1500 Intruder, (WVAL) 1998-2004					
Protection Guard, big design		7433 DG SU VL 1500	Piece	208,38	247,97
Fender Guard, front		7441 RL SU VL 1500	Piece	134,20	159,70
For Suzuki VZ 1600 Marauder, (VNT60B/K4) 2004 and M 1600 Intruder, (VNT60B/K5) 2005					
Protection Guard, big design from tube 30 mm		7703 DG KA VN 1500 Mean Streak	Piece	234,67	279,26
Mounting Bar for additional Spotlights		7706 LH KA VN 1500 Mean Streak	Piece	69,36	82,54
For Suzuki C 1800 R Intruder (VLR 1800), (WVCT) 2008-2012					
Protection Guard, extra big design from tube 38 mm		7901 DGX SU C 1800 R	Piece	267,73	318,60
Mounting Bar for additional Spotlights		7905 LH SU C 1800 R	Piece	69,36	82,54
For Suzuki M 1800 R/R2 Intruder (VZR 1800), (WVCA) 2006-					
Protection Guard one piece from tube 38 mm		7404 DGX SU M 1800 R	Piece	267,73	318,60
Sissy Bar made from tube with pad and carrier		7411 RG SU M 1800 R	Piece	236,31	281,21

Triumph

Article:	Fits for:	Order No.:		EUR without Tax	EUR incl. 19% Tax
For Triumph Tiger 800, (A08) 2011-2014 and Tiger 800 XC, (A08/XC) 2011-2014					
Enduro Protection Guard, black		6056 ES TR Tiger 800	Pair	232,47	276,64
Protection Guard, black		6057 SE TR Tiger 800	Pair	161,16	191,78
For Triumph Tiger 800 XC/XCX/XCA, (T800XC / TIGXC) 2015-2019 and Tiger 800 XR/XRX/XRT, (T800XR /TIGXR) 2015-2019					
Enduro Protection Guard, above, black		7973 ES TR Tiger 800 XC/XR	Pair	232,47	276,64
(7973 can not be mounted together with the original protection guard)					



7973 ES TR Tiger 800 XC/XR

For Triumph Thruxton 900, (986ME2) 2008-2015

Protection Guard		6074 D TR Bonneville T 100	Piece	161,16	191,78
Baggage Holder		7942 P TR Thruxton 900	Pair	95,04	113,10
Luggage Carrier		7943 G TR Thruxton 900	Piece	150,91	179,58



6074 D TR Bonneville T 100



7942 P TR Thruxton 900



7943 G TR Thruxton 900

For Triumph Bonneville T 100 and SE, (986MF) 2005-2016 and Scrambler, (986MG2) 2008-2016

Protection Guard		6074 D TR Bonneville T 100	Piece	161,16	191,78
Baggage Holder	Bonneville	6075 P TR Bonneville T 100	Pair	95,04	113,10
Baggage Holder, one-sided left	Scrambler	6081 P TR Scrambler, links	Piece	47,52	56,55
Luggage Carrier		6076 G TR Bonneville T 100	Piece	150,91	179,58
Handhold, left		6077 HG TR Bonneville T 100	Piece	37,58	44,72

For Triumph Bonneville T 100, (T100) 2017-

Protection Guard, black		7919 D TR Bonneville T 120, schwarz	Piece	161,16	191,78
Sissy Bar made from tube with pad and carrier		6180 RG TR Bonneville T 100 Bj. 17	Piece	236,31	281,21
Dto., black		6181 RG TR Bonneville T 100 Bj. 17, schw.	Piece	236,31	281,21
Handhold, left		6182 HG TR Bonneville T 100 Bj. 17	Piece	37,58	44,72
Side Case Holder for Givi/Kappa (Monokey) Cases		6186 ST TR Bonneville T 100 Bj. 17	Pair	217,04	258,28
Dto., black		6187 ST TR Bonneville T 100 Bj. 17, schw.	Pair	217,04	258,28



7919 D TR Bonneville T 120



6180 RG TR Bonneville T 100 Bj. 17

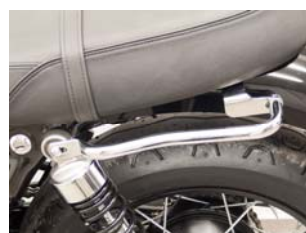

6182 HG TR Bonneville T 100 Bj. 17



6186 ST TR Bonneville T 100 Bj. 17

Article:	Fits for:	Order No.:		EUR without Tax	EUR incl. 19% Tax
For Triumph Bonneville Bobber, (D76) 2017- Solo-Rack Ø 16, black shiny (To assemble the Solo-Rack it is nessecary to carry out four drillings!)		7900 BR TR Bonneville Bobber	Piece	127,12	151,27



7900 BR TR Bonneville Bobber, schwarz

For Triumph Street Cup, (77G) 2017-

Protection Guard
Baggage Holder
Luggage Carrier

7863 D TR Street Cup	Piece	161,16	191,78
7865 P TR Street Cup	Pair	95,04	113,10
7866 G TR Street Cup	Piece	150,91	179,58



7863 D TR Street Cup



7865 P TR Street Cup



7866 G TR Street Cup

For Triumph Street Twin, (74G) 2016-

Protection Guard, black
Luggage Carrier, black
Side Case Carrier for Givi/Kappa (Monokey) Cases
Dto., black

7919 D TR Bonneville T 120, schwarz	Piece	161,16	191,78
7929 G TR Street Twin, schwarz	Piece	150,91	179,58
7930 ST TR Street Twin	Pair	217,04	258,28
7931 ST TR Street Twin, schwarz	Pair	217,04	258,28



7919 D TR Bonneville T 120, schwarz



G TR Street Twin



7930 ST TR Street Twin

**For Triumph America, (T986MK / MK2) 2007-
and Speedmaster, (986ML2) 2008-2017**

Protection Guard, big design from tube 30 mm
Baggage Holder
Luggage Carrier
Sissy Bar made from tube with pad and carrier
Sissy Bar made from tube with pad and carrier
Deco Cover Set, Battery box left

Speedmaster
America
Speedmaster
America, Speedmaster ex 2011

6063 DG TR America/Speedmaster	Piece	234,67	279,26
6064 P TR America/Speedmaster	Pair	95,04	113,10
6071 G TR Speedmaster	Piece	150,91	179,58
6066 RG TR America	Piece	236,31	281,21
6072 RG TR Speedmaster	Piece	236,31	281,21
6069 ZB1 TR America/Speedmaster	Piece	62,59	74,48

For Triumph Tiger 955i, (709EN) 2002-2006

Enduro Protection Guard, black

7989 ES TR Tiger 955i	Pair	193,92	230,76
-----------------------	------	--------	--------

Article:	Fits for:	Order No.:		EUR without Tax	EUR incl. 19% Tax
For Triumph Bonneville T 120, (75HW) 2016-2020					
Protection Guard, black		7919 D TR Bonneville T 120, schwarz	Piece	161,16	191,78
Baggage Holder		7920 P TR Bonneville T 120	Pair	95,04	113,10
Baggage Holder, black		7921 P TR Bonneville T 120, schwarz	Pair	95,04	113,10
Luggage Carrier		7922 G TR Bonneville T 120	Piece	150,91	179,58
Side Case Holder for Givi/Kappa (Monokey) Cases		7924 ST TR Bonneville T 120	Pair	217,04	258,28
Side Case Holder for Givi/Kappa (Monokey) Cases, black		7925 ST TR Bonneville T 120, schwarz	Pair	217,04	258,28



7919 D TR Bonneville T 120, schwarz



7920 P TR Bonneville T 120



7922 G R Bonneville T 120



7924 ST TR Bonneville T 120

For Triumph Thruxton 1200, (71H4) 2016-2019 and Thruxton 1200 R, (72H4) 2016-2019

Protection Guard
Baggage Holder

7913 D TR Thruxton 1200	Piece	161,16	191,78
7914 P TR Thruxton 1200	Pair	95,04	113,10

For Triumph Tiger Explorer, (V13VG) 2012-2015 and Tiger Explorer XC, (TIGEPXC/13) 2013-2015

Protection Guard, above, black

7981 ES TR Tiger Explorer	Pair	232,47	276,64
---------------------------	------	--------	--------

For Triumph Thunderbird 1600, (NB10/11) 2009- and Thunderbird Storm, (NB13) 2011-

Protection Guard, extra big design from tube 38 mm
Baggage Holder
Rearrack
Solo-Rack
Mounting Bar for additional Spotlights Thunderbird 1600
Sissy Bar made from tube with pad and carrier
Driver Sissy Bar with pad and Carrier

6088 DGX TR Thunderbird	Piece	267,73	318,60
6089 P TR Thunderbird	Pair	95,04	113,10
6090 RR TR Thunderbird	Piece	130,66	155,49
6091 BR TR Thunderbird	Piece	127,12	151,27
6093 LH TR Thunderbird	Piece	69,36	82,54
6094 RG TR Thunderbird	Piece	236,31	281,21
6095 FRG TR Thunderbird	Piece	292,13	347,63

For Triumph Thunderbird Commander 1700, (NB15) 2014- and Thunderbird LT 1700, (NB17) 2014-

Protection Guard, extra big design from tube 38 mm
Baggage Holder
Rearrack
Solo-Rack
Sissy Bar made from tube with pad and carrier
Driver Sissy Bar with pad and Carrier

6172 DGX TR Thunderbird Comm. LT	Piece	267,73	318,60
6089 P TR Thunderbird	Pair	95,04	113,10
6173 RR TR Thunderbird Comm. LT	Piece	130,66	155,49
6091 BR TR Thunderbird	Piece	127,12	151,27
6174 RG TR Thunderbird Comm. LT	Piece	236,31	281,21
6175 FRG TR Thunderbird Comm. LT	Piece	292,13	347,63



6172 DGX TR Thunderbird Comm. LT



6089 P TR Thunderbird



6173 RR TR Thunderbird Comm. LT



6091 BR TR Thunderbird

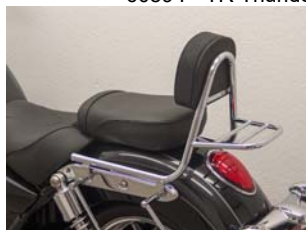

Article:	Fits for:	Order No.:		EUR without Tax	EUR incl. 19% Tax
For Triumph Rocket III Roadster, (C23XB) 2010-2017					
Protection Guard, extra big design from tube 38 mm, 2 pcs.		6082 DGX TR Rocket III Roadster	Pair	267,73	318,60
Baggage Holder		6083 P TR Rocket III Roadster	Pair	95,04	113,10
Sissy Bar made from tube with pad and carrier		6086 RG TR Rocket III Roadster	Piece	236,31	281,21
Driver Sissy Bar with pad and Carrier		6087 FRG TR Rocket III Roadster	Piece	292,13	347,63

Victory

Article:	Fits for:	Order No.:		EUR without Tax	EUR incl. 19% Tax
For Victory Vegas, Vegas 8 Ball, Vegas High Ball and Vegas Kingpin					
Solo Rack from sheet metal, black		6101 BRB VI Vegas schwarz	Piece	127,12	151,27

Yamaha

Article:	Fits for:	Order No.:		EUR without Tax	EUR incl. 19% Tax
For Yamaha XV 125 Virago, (XV125) 1991-2002 and XV 250 Virago, (3LW) 1989-2000					
Baggage Holder		7497 P YA XV 125/250	Pair	95,04	113,10
For Yamaha XVS 125 Drag Star, (VE01) 2000-					
Protection Guard		7580 D YA XVS 125 Drag Star	Piece	133,90	159,34
Sissy Bar made from tube with pad and carrier		7584 RG YA XVS 125 Drag Star	Piece	236,31	281,21
For Yamaha XV 535 Virago, (2YL/3BR/4MC) 1988-2003					
Protection Guard 2 pcs.		7500 D YA XV 535	Pair	208,38	247,97
Luggage Carrier		7505 G YA XV 535	Piece	150,91	179,58
Baggage Holder	up to 1998	7498 P YA XV 535 bis Bj. 98	Pair	95,04	113,10
Baggage Holder	since 1999	7504 P YA XV 535 ab Bj. 99	Pair	95,04	113,10
Mounting Bar for additional Spotlights		7493 LH YA XV 535	Piece	69,36	82,54
For Yamaha XJ 550/600/650/750/900 (alle Modelle), 1981-2003					
Engine Protection Guard, solid (The Engine Guard can not be mounted together with the engine fairing)		7028 MS YA XJ 550-900	Pair	120,05	142,86
For Yamaha FZS 600 Fazer, (RJ2) 2000-2003					
Engine Protection Guard, solid, black		7490 MS YA FZS 600 Fazer	Pair	120,05	142,86
For Yamaha XJ 600 S Diversion, (4BR/RJ01) 1991-2003					
Engine Protection Guard, solid		7507 MS YA XJ 600 S Diversion	Pair	120,05	142,86
For Yamaha XVS 650 Drag Star, (4VR/4XR) 1996-2003					
Protection Guard, big design		7521 DG YA XVS 650 Drag Star	Piece	208,38	247,97
Mounting Bar for additional Spotlights		7557 LH YA XVS 1100 Drag Star	Piece	69,36	82,54
For Yamaha XVS 650 Drag Star Classic, (VM02/3/4) 1998-2007					
Protection Guard, big design		7533 DG YA XVS 650 Drag Star Classic	Piece	208,38	247,97
Fender Guard, front		7539 RL YA XVS 650 Drag Star Classic	Piece	134,20	159,70
Mounting Bar for additional Spotlights		7548 LH YA XVS 650 Drag Star Classic	Piece	69,36	82,54
For Yamaha XT 660 R, (DM014) 2004-2016 and XT 660 X, (DM011) 2004-2016					
Enduro Protection Guard, black		7564 ES YA XT 660 R	Pair	193,92	230,76
Luggage Carrier, black		7565 G YA XT 660 R	Piece	150,91	179,58

Article:	Fits for:	Order No.:		EUR without Tax	EUR incl. 19% Tax
For Yamaha MT-07, (RM04, RM17, RM18) 2014-2017					
Protection Guard, above, black		7491 ES YA MT-07	Pair	193,92	230,76
(The Protection Guard does not fit the model with the indicator mounted on the radiator cover.)					
Baggage Holder, black		7488 P YA MT-07	Pair	95,04	113,10
Luggage Carrier, black		7489 G YA MT-07	Piece	150,91	179,58



7491 ES YA MT-07



7488 P YA MT-07



7489 G YA MT-07

For Yamaha MT-07 (with indicator on the radiator cover), (RM17, RM18, RM33) 2018-2020

Baggage Holder, black		7488 P YA MT-07	Pair	95,04	113,10
Luggage Carrier, black		7489 G YA MT-07	Piece	150,91	179,58



7488 P YA MT-07



7489 G YA MT-07

For Yamaha MT-07 Tracer 700, (RM14, RM15) 2016- 2019 and (RM30) 2019-2020

Baggage Holder, black		7537 P YA MT-07 Tracer	Pair	95,04	113,10
Luggage Carrier, black		7538 G YA MT-07 Tracer	Piece	150,91	179,58



7537 P YA MT-07 Tracer



7538 G YA MT-07 Tracer

For Yamaha XSR 700, (RM11, RM12) 2016-2020

Protection Guard, above, black		7554 ES YA XSR 700	Pair	193,92	230,76
Baggage Holder, black		7555 P YA XSR 700	Pair	95,04	113,10
Luggage Carrier, black		7556 G YA XSR 700	Piece	150,91	179,58

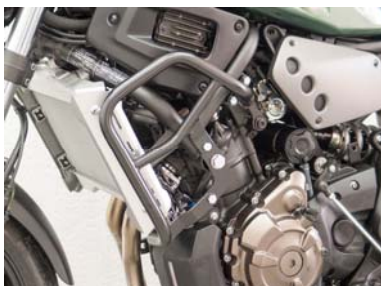

7554 ES YA XSR 700



7555 P YA XSR 700



7556 G YA XSR 700

Article:	Fits for:	Order No.:		EUR without Tax	EUR incl. 19% Tax
For Yamaha XV 750 Virago, (4FY/4PW) 1992-1998 and XV 1100 Virago, (3LP) 1989-1999					
Protection Guard 2 pcs.		7595 D YA XV 750/1100 Virago	Pair	208,38	247,97
Protection Guard (This Protection Guard can be mounted together with advanced footpegs)		7592 SE YA XV 1100 Virago	Pair	105,96	126,09
Baggage Holder		7596 P YA XV 750/1100 Virago	Pair	95,04	113,10
Mounting Bar for additional Spotlights (By Yamaha XV 750/1100 you have to change the turn lights (for example against handlebar turn lights) when you mount the Lightbar)		7597 LH YA XV 750/1100	Piece	69,36	82,54
For Yamaha MT-09/ABS, (RN29) 2013-2016					
Engine Protection Guard, solid, black		7522 SE YA MT-09	Pair	161,16	191,78
Luggage Carrier, black		7524 G YA MT-09	Piece	150,91	179,58
For Yamaha MT-09, (RN43) 2017-2020					
Engine Protection Guard, black		7522 SE YA MT-09	Pair	161,16	191,78
Luggage Carrier, black		7531 G YA MT-09 Bj. 17	Piece	150,91	179,58



7522 SE YA MT-09



7531 G YA MT-09 Bj. 17

For Yamaha MT-09 Tracer, (RN43) 2017-2020

Engine Protection Guard, black
Luggage Carrier, black

7522 SE YA MT-09	Pair	161,16	191,78
7545 G YA MT-09 Tracer Bj. 17	Piece	150,91	179,58



7522 SE YA MT-09



7545 G YA MT-09 Tracer Bj. 17

For Yamaha XJ 900 S Diversion, (4KM) 1994-2003

Protection Guard pair

7510 Z YA XJ 900 S Diversion	Pair	155,06	184,52
------------------------------	------	--------	--------

For Yamaha XSR 900, (RN43) 2016-

Engine Protection Guard, black
Baggage Holder, black
Luggage Carrier, black

7522 SE YA MT-09	Pair	161,16	191,78
7593 P YA XSR 900	Pair	95,04	113,10
7594 G YA XSR 900	Piece	150,91	179,58



7522 SE YA MT-09



7593 P YA XSR 900



7594 G YA XSR 900

Article:	Fits for:	Order No.:		EUR without Tax	EUR incl. 19% Tax
For Yamaha SCR 950, (VN07) 2017-2020					
Protection Guard, black		7560 E YA SCR 950	Piece	161,16	191,78
Baggage Holder, black		7562 P YA SCR 950	Pair	95,04	113,10
Luggage Carrier, black		7561 G YA SCR 950	Piece	150,91	179,58



7560 E YA SCR 950



7562 P YA SCR 950



7561 G YA SCR 950

For Yamaha XV 950 R, (VN03, VN075) 2013-2020

Protection Guard, extra big design from tube 38 mm, black
Baggage Holder, black
Rearrack, black
Solo-Rack, black
Solo-Rack from sheet metal, black
Sissy Bar made from tube with pad and carrier, black

6130 DGX YA XV 950 R	Piece	256,20	304,88
6131 P YA XV 950 R	Pair	95,04	113,10
6132 RR YA XV 950 R	Piece	130,66	155,49
6133 BR YA XV 950 R	Piece	127,12	151,27
6134 BRB YA XV 950 R	Piece	127,12	151,27
6136 RG YA XV 950 R	Piece	236,31	281,21



6130 DGX YA XV 950 R



6131 P YA XV 950 R



6132 RR YA XV 950 R



6133 BR YA XV 950 R



6134 BRB YA XV 950 R



6136 RG YA XV 950 R

For Yamaha XV 950 Racer, (NO39) 2016-2017

Protection Guard, extra big design from tube 38 mm, black
Baggage Holder, black
Rearrack, black

6130 DGX YA XV 950 R	Piece	256,20	304,88
6131 P YA XV 950 R	Pair	95,04	113,10
6132 RR YA XV 950 R	Piece	130,66	155,49



6130 DGX YA XV 950 R



6131 P YA XV 950 R



6132 RR YA XV 950 R

For Yamaha XVS 950 A Midnight Star, (VN02) 2009-2015

Protection Guard, extra big design from tube 38 mm

7600 DGX YA XVS 950 A	Piece	256,20	304,88
-----------------------	-------	--------	--------

Article:	Fits for:	Order No.:		EUR without Tax	EUR incl. 19% Tax
For Yamaha XVS 1100 Drag Star, (VP05) 1999-2002					
Protection Guard, big design from tube 30 mm		7546 DG YA XVS 1100 Drag Star	Piece	234,67	279,26
Baggage Holder		7547 P YA XVS 1100 Drag Star	Pair	95,04	113,10
Mounting Bar for additional Spotlights		7557 LH YA XVS 1100 Drag Star	Piece	69,36	82,54
For Yamaha XVS 1100 Drag Star Classic, (VP16) 2001-2007					
Protection Guard, big design from tube 30 mm		7570 DG YA XVS 1100 Drag Star Classic	Piece	234,67	279,26
Baggage Holder		7547 P YA XVS 1100 Drag Star	Pair	95,04	113,10
Rearrack		7571 RR YA XVS 1100 Drag Star Classic	Piece	130,66	155,49
Fender Guard, front		7577 RL YA XVS 1100 Drag Star Classic	Piece	134,20	159,70
Mounting Bar for additional Spotlights		7578 LH YA XVS 1100 Drag Star Classic	Piece	69,36	82,54
For Yamaha V-Max, (2EN, 2LT) 1985-2002					
Engine Protection Guard, solid		7514 MS YA V-Max	Pair	120,05	142,86
Baggage Holder		7515 P YA V-Max	Pair	95,04	113,10
Rearrack (2EN) (short tail)		7516 RR YA V-Max	Piece	130,66	155,49
Mounting Bar for additional Spotlights		7597 LH YA XV 750/1100	Piece	69,36	82,54
(By Yamaha V-Max you have to change the turn lights (for example against handlebar turn lights) when you mount the Lightbar)					
For Yamaha XJR 1200, (4PU) 1994-1998 and XJR 1300, (RP02, RP06, RP10, RP19) 1999-2014					
Engine Protection Guard, solid		7511 MS YA XJR 1200/1300	Pair	120,05	142,86
Luggage Carrier		7513 G YA XJR 1200/1300	Piece	150,91	179,58
For Yamaha XJR 1300, (XJR13, XJR15) 2015-2016					
Engine Protection Guard, solid		7508 MS YA XJR 1300	Pair	120,05	142,86
Baggage Holder		7509 P YA XJR 1300	Pair	95,04	113,10
Luggage Carrier		7512 G YA XJR 1300	Piece	150,91	179,58



7508 MS YA XJR 1300



7509 P YA XJR 1300



7512 G YA XJR 1300

For Yamaha XVS 1300 Midnight Star, (VP26) 2007-2016

Protection Guard, extra big design from tube 38 mm	6000 DGX YA XVS 1300	Piece	267,73	318,60
Baggage Holder	6001 P YA XVS 1300	Pair	95,04	113,10
Fender Guard, front	6004 RL YA XVS 1300	Piece	134,20	159,70
Sissy Bar made from tube with pad and carrier	6006 RG YA XVS 1300	Piece	236,31	281,21

For Yamaha XVS 1300 Custom, (VP36) 2014-2016

Protection Guard, extra big design from tube 38 mm, black	7572 DGX YA XVS 1300 Custom	Piece	267,73	318,60
Baggage Holder, black	7573 P YA XVS 1300 Custom	Pair	95,04	113,10
Rearrack, black	7574 RR YA XVS 1300 Custom	Piece	130,66	155,49
Sissy Bar made from tube with pad and carrier, black	7576 RG YA XVS 1300 Custom	Piece	236,31	281,21



7572 DGX YA XVS 1300 Custom



7573 P YA XVS 1300 Custom



7574 RR YA XVS 1300 Custom



7576 RG YA XVS 1300 Custom

For Yamaha XVZ 1300 A Royal Star, (4NK, 4YP) 1996-2000

Protection Guard, big design from tube 30 mm	7529 DG YA XVZ 1300 A Royal Star	Piece	234,67	279,26
Fender Guard, front	7532 RL YA XVZ 1300 A Royal Star	Piece	134,20	159,70

For Yamaha XV 1600 Wild Star, (VP08) 1999-2004

Protection Guard, big design from tube 30 mm	7559 DG YA XV 1600 Wild Star	Piece	234,67	279,26
Fender Guard, front	7566 RL YA XV 1600 Wild Star	Piece	134,20	159,70
Mounting Bar for additional Spotlights	7563 LH YA XV 1600 Wild Star	Piece	69,36	82,54

Accessories

Article:	Fits for:	Order No.:		EUR without Tax	EUR incl. 19% Tax
Headlight Protector Headlight Protector for 19 cm lights		7870 LB U 19	Piece	25,38	30,20
Device Holder for mounting on the handlebar holder Device holder low with 18 mm tube Side panel stainless steel 20 mm high, tube black (Fastening distance 100 x 32 – 44 mm) with distance piece 14 mm and M 8 x 45/50 Allen screw		6213 Gerätehalter niedrig	Piece	58,74	69,90
Device holder high with 18 mm tube Side panel stainless steel 55 mm high, tube black (Fastening distance 100 x 32 – 44 mm) with distance piece 14 mm and M 8 x 45/50 Allen screw		6214 Gerätehalter, hoch	Piece	61,31	72,96



6213 Gerätehalter niedrig



6214 Gerätehalter hoch

Handlebar holder / Riser

To expand our product range and as a supplement to our motorcycle handlebars, we have taken over the riser production line from Müller Motorcycle AG. The risers have a beautiful appearance and are neatly finished. The riser covers are invisibly screwed from below. Made of high-strength aircraft aluminium. So you always have a firm grip on your handlebars.

Our Riser exist for **25,4 mm (1")** and **31,75 mm (1 ¼")** handlebars, in **50, 75 and 100 mm** Height, in polished or black anodised. With 1/2" UNC thread.

All our Riser inclusive Technical Report for registration pursuant § 19 (3).



Riser 50 mm high

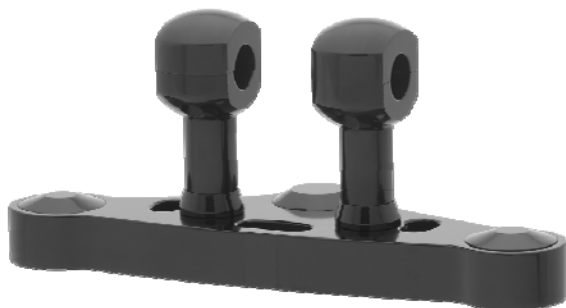

Riser 75 mm high



Riser 100 mm high

Article:	Order No.:		EUR without Tax	EUR incl. 19% Tax
		a b c d		
Aluminium Riser for 25,4 mm (1") handlebars.				
Alu-Riser for handlebar with 25,4 mm Ø, 50 mm high, polished	7414 LR 1-1-2-1		Pair 139,75	166,30
Alu-Riser for handlebar with 25,4 mm Ø, 75 mm high, polished	7416 LR 1-2-2-1		Pair 152,90	181,95
Alu-Riser for handlebar with 25,4 mm Ø, 100 mm high, polished	7418 LR 1-3-2-1		Pair 165,25	196,65
Alu-Riser for handlebar with 25,4 mm Ø, 50 mm high, black anodised	7415 LR 1-1-2-5		Pair 169,20	201,35
Alu-Riser for handlebar with 25,4 mm Ø, 75 mm high, black anodised	7417 LR 1-2-2-5		Pair 182,35	217,00
Alu-Riser for handlebar with 25,4 mm Ø, 100 mm high, black anodised	7419 LR 1-3-2-5		Pair 194,45	231,40
Aluminium Riser for 31,75 mm (1 ¼") handlebars.				
Alu-Riser for handlebar with 31,75 mm Ø, 50 mm high, polished	7420 LR 1-1-4-1		Pair 139,75	166,30
Alu-Riser for handlebar with 31,75 mm Ø, 75 mm high, polished	7427 LR 1-2-4-1		Pair 152,90	181,95
Alu-Riser for handlebar with 31,75 mm Ø, 100 mm high, polished	7430 LR 1-3-4-1		Pair 165,25	196,65
Alu-Riser for handlebar with 31,75 mm Ø, 50 mm high, black anodised	7421 LR 1-1-4-5		Pair 169,20	201,35
Alu-Riser for handlebar with 31,75 mm Ø, 75 mm high, black anodised	7428 LR 1-2-4-5		Pair 182,35	217,00
Alu-Riser for handlebar with 31,75 mm Ø, 100 mm high, black anodised	7431 LR 1-3-4-5		Pair 194,45	231,40

Handlebars with TÜV - Technical Report

Handlebars from tube 22 mm Ø (7/8")

Straight

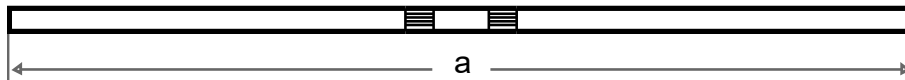

Article:	Order No.:	EUR without Tax	EUR incl. 19% Tax
	a		
Straight from tube 22 mm Ø (7/8")			
Straight	985 7013 Straight	Piece 45,93	54,66
Straight 2	845 7014 Straight 2	Piece 41,42	49,29
Dto., black	7050 Straight 2, schwarz	Piece 41,42	49,29

Drag Bars

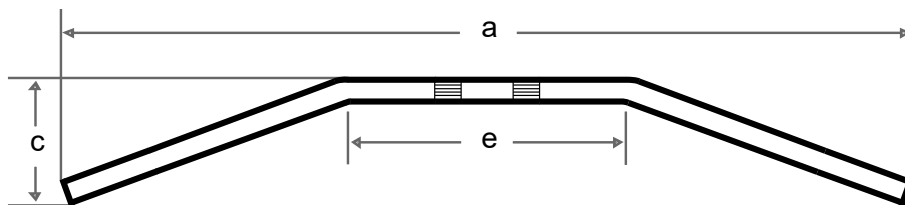

Article:	a	c	e	Order No.:	EUR without Tax	EUR incl. 19% Tax
Drag-Bars from tube 22 mm Ø (7/8")						
Drag-Bar, 635 mm wide	635	135	190	7303 L D 2	Piece 43,68	51,98
Drag-Bar, 720 mm wide	720	165	230	7089 L D 3	Piece 50,75	60,39
Drag-Bar, 820 mm wide	820	165	330	7086 L D 7	Piece 50,75	60,39
Dto., black				7004 L D 7, schwarz	Piece 50,75	60,39
Drag-Bar, 970 mm wide	970	165	345	7017 L D 9	Piece 59,41	70,70
Dto., black				7018 L D 9, schwarz	Piece 59,41	70,70
Drag-Bar, 1030 mm wide	1030	180	375	7030 L D 10	Piece 59,41	70,70
Drag-Bar, 755 mm wide	755	65	310	7082 L D 11	Piece 50,75	60,39
Dto., black				7062 L D 11, schwarz	Piece 50,75	60,39

Superbike and Streetbike Handlebars

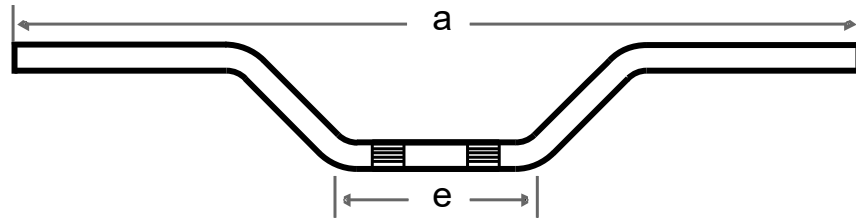
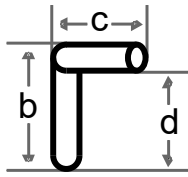

Article:						Order No.:		EUR without Tax	EUR incl. 19% Tax
	a	b	c	d	e				
Streetbike-Handlebar from tube 22 mm Ø (7/8")									
Streetbike-Handlebar	755	50	60	30	125	7006 LN 61	Piece	56,49	67,22
Superbike-Handlebar from tube 22 mm Ø (7/8")									
Superbike-Handlebar, high	740	105	120	90	180	7780 LN 11	Piece	56,49	67,22
Superbike-Handlebar, small	660	80	90	60	200	7790 LN 18	Piece	52,95	63,01
Superbike-Bar, small, strong cranked	680	85	125	55	200	7791 LN 19	Piece	56,49	67,22
Superbike-Handlebar, small	710	75	105	100	210	7007 LN 43	Piece	56,49	67,22
Superbike-Handlebar	760	75	105	100	260	7008 LN 44	Piece	56,49	67,22
Dto., black						7098 LN 44 schwarz	Piece	56,49	67,22
Superbike-Handlebar, wide	810	75	105	100	310	7011 LN 45	Piece	60,33	71,79
Superbike-Handlebar, high	870	135	120	150	200	7053 LN 46	Piece	60,33	71,79
Dto., black						7052 LN 46 schwarz	Piece	60,33	71,79

Touring Handlebars

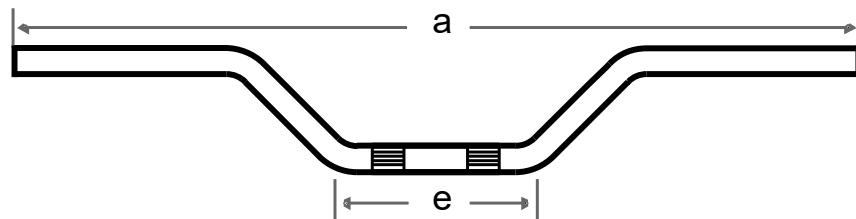
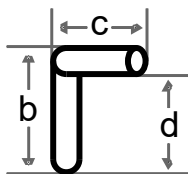

Article:						Order No.:		EUR without Tax	EUR incl. 19% Tax
	a	b	c	d	e				
Handlebar from tube 22 mm Ø (7/8")									
Classic Handlebar like BMW /5 models	650	60	70	55	200	7191 LN 1	Piece	56,85	67,65
Streetbike and side car Handlebar	750	60	85	55	200	7087 LN 2	Piece	60,33	71,79
Classic touring Handlebar like BMW /6	660	105	105	110	200	7194 LN 4	Piece	60,33	71,79
Touring Handlebar, medium high	765	145	175	115	245	7195 LN 5	Piece	61,98	73,76
Touring Handlebar	745	235	165	220	250	7781 LN 12	Piece	61,98	73,76
Touring Handlebar	730	120	105	140	160	7784 LN 14	Piece	61,98	73,76
Classic touring Handlebar like Z 650	730	90	120	110	160	7793 LN 21	Piece	60,33	71,79
Classic touring Handlebar like BMW R 80 G/S, R 80 RT/ST, R 100 RT	710	200	135	260	180	7794 LN 22	Piece	61,98	73,76
Classic Touring Bar like YA SR 500	800	120	155	150	170	7060 LN 25	Piece	61,98	73,76
Dto., black						7063 LN 25 schwarz	Piece	61,98	73,76
Touring Handlebar	710	110	80	100	175	7080 LN 26	Piece	60,33	71,79
Touring Handlebar	745	170	150	155	175	7204 LN 27	Piece	61,98	73,76
Handlebar, low and wide	920	100	110	70	250	7202 LN 33	Piece	61,98	73,76

Chopper- and Cruiser Handlebars

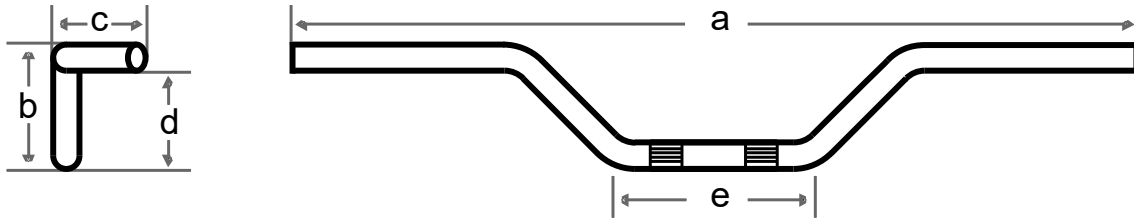

Article:

Order No.:

EUR
without
Tax

EUR
incl. 19%
Tax

	a	b	c	d	e		EUR without Tax	EUR incl. 19% Tax
Handlebar from tube 22 mm Ø (7/8")								
Classic and stylish Handlebar, high	830	250	170	230	280	7806 LN B	Piece 65,82	78,33
Chopper Handlebar	745	200	200	150	250	7787 LN 17	Piece 65,82	78,33
Chopper Handlebar	755	180	230	75	240	7795 LN 23	Piece 65,82	78,33
Handlebar, medium high and wide	990	125	220	130	230	7798 LN 40	Piece 75,76	90,15
Handlebar, low and wide	920	60	150	25	220	7054 LN 42	Piece 63,26	75,28
Handlebar, low and wide	950	85	165	90	210	7190 LN 48 *	Piece 69,66	82,90
Handlebar, low and wide, strong cranked	865	85	130	220	190	7188 LN 50 *	Piece 69,66	82,90
Hb., medium high, wide, strong cranked	1020	160	275	120	395	7110 LN 56 *	Piece 75,76	90,15

* Marked handlebars with TÜV technical report for registration pursuant §19/2.

T-Bars

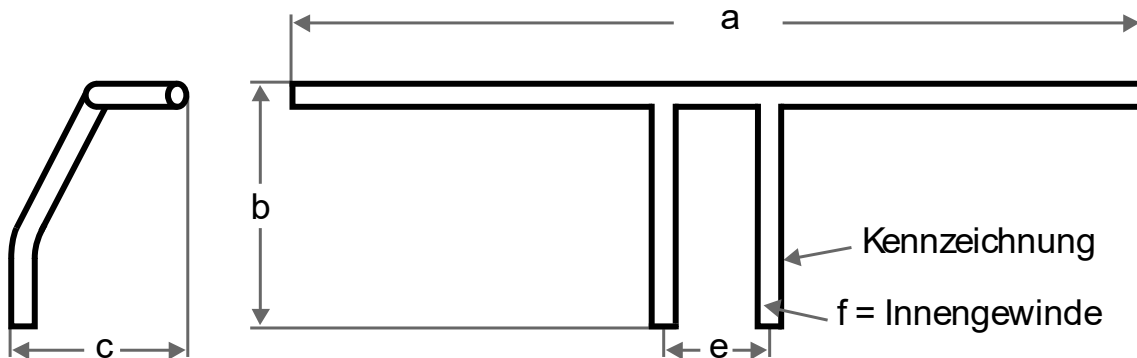

T-Bar handlebar with thread in the vertical tubes (hole distance 100 mm). The handlebars are mounted with a screw on the triple tree. The screw must be mounted from below through the triple tree inside the vertical handlebar tubes. For some motorcycle models we have mounting kits, for other models you have to make the mounting like the description of the TÜV-technical report.

Article:

Order No.:

EUR
without
Tax

EUR
incl. 19%
Tax

	a	b	c	e	f		EUR without Tax	EUR incl. 19% Tax
T-Bars								
T-Bar Ø 22 mm	800	225	160	100	M 10	7958 T-Bar 1	Piece 170,80	203,25
Mounting kits:								
Mounting kit for T-Bar Handlebar Honda VT 125 Shadow						7966 MK HO VT 125 Shadow	Piece 33,73	40,14
Mounting kit for T-Bar Yamaha XV 250/535 and XV 750/1100 Virago						7991 MK YA XV 250/535	Piece 22,45	26,72

LZR- and ULZ-Handlebars

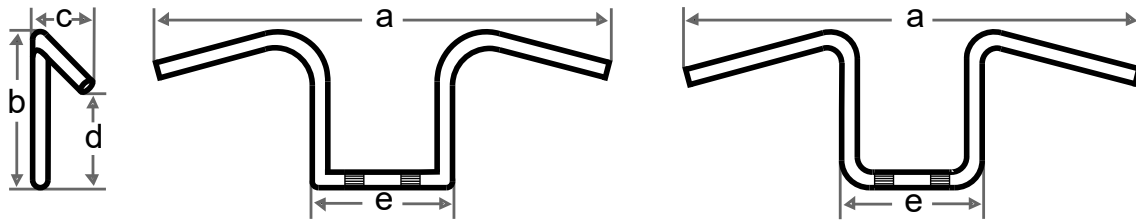

Article:		Order No.:	EUR without Tax	EUR incl. 19% Tax
	a b c d e			
LZR-Handlebar from tube 22 mm Ø (7/8")				
Z-Handlebar, high, top round, black	720 280 140 245 240	7797 L ZR 2, schwarz	Piece 156,04	185,69
ULZ-Handlebar from tube 22 mm Ø (7/8")				
Z-Handlebar, curved	750 250 110 175 240	7803 UL Z	Piece 67,71	80,58

Z-Handlebars

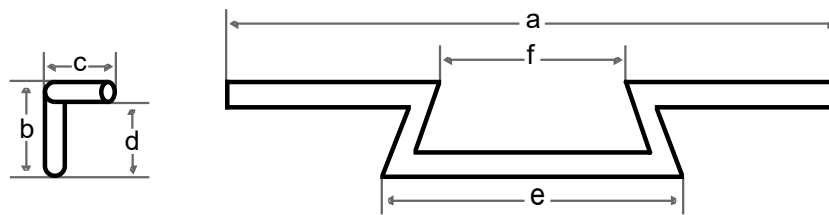

Article:		Order No.:	EUR without Tax	EUR incl. 19% Tax
	a b c d e			
Z-Handlebar from tube 22 mm Ø (7/8")				
Inclusive Technical Report for registration pursuant § 19/2				
Z-Handlebar, low, small	870 85 120 50 300	7733 L Z 7	Piece 168,85	200,93
Dto., black		7734 L Z 7, schwarz	Piece 168,85	200,93
Z-Handlebar, high, small	850 145 120 110 300	7736 L Z 9	Piece 168,85	200,93
Dto., black		7737 L Z 9, schwarz	Piece 168,85	200,93

M-Handlebar

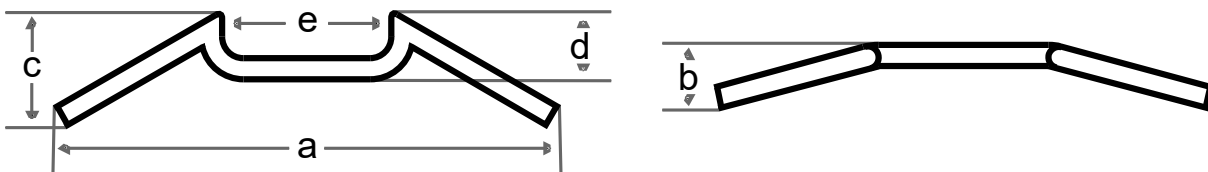

Article:		Order No.:	EUR without Tax	EUR incl. 19% Tax
	a b c d e			
M-Handlebar from tube 22 mm Ø (7/8")				
M-Handlebar	575 104 150 67 230	7093 HK L 3	Piece 73,81	87,83
Dto., black		7040 HK L 3, schwarz	Piece 73,81	87,83
M-Handlebar	617 59 190 90 240	7949 L M 2	Piece 77,04	91,68
M-Handlebar	610 85 200 145 290	7540 YA L 2	Piece 90,52	107,72
Dto., black		7096 YA L 2, schwarz	Piece 90,52	107,72
M-Handlebar	694 105 162 134 300	7309 HO L 10	Piece 90,52	107,72

Enduro / Moto-Cross Handlebars

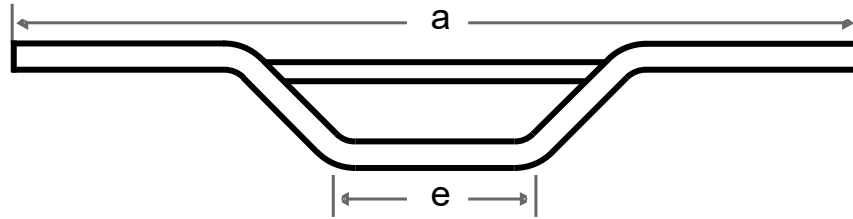
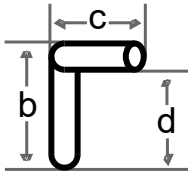

Article:

Order No.:

EUR
without
Tax

EUR
incl. 19%
Tax

	a	b	c	d	e			EUR without Tax	EUR incl. 19% Tax	
Off-Road Handlebars from tube 22 mm Ø (7/8")										
Off-Road-Handlebar	890	130	75	120	220	7893	CL 3	Piece	64,54	76,80
Dto., black						7894	CL 3, schwarz	Piece	64,54	76,80
Off-Road-Handlebar, black	880	130	120	150	240	7896	CL 4, schwarz	Piece	64,54	76,80
Off-Road-Handlebar	795	100	100	145	210	7897	CL 5	Piece	64,54	76,80
Dto., black						7898	CL 5, schwarz	Piece	64,54	76,80
Off-Road-Handlebar	900	130	95	155	200	7883	CL N	Piece	64,54	76,80
Dto., black						7205	CL N, schwarz	Piece	64,54	76,80
Off-Road-Handlebar	880	150	120	185	200	7884	CL H	Piece	64,54	76,80
Dto., black						7216	CL H, schwarz	Piece	64,54	76,80
Off-Road-Handlebar, Strut 22 mm	750	150	90	180	200	7196	BMW L 6	Piece	64,54	76,80
Dto., black						7192	BMW L 6, schwarz	Piece	64,54	76,80

Clamps

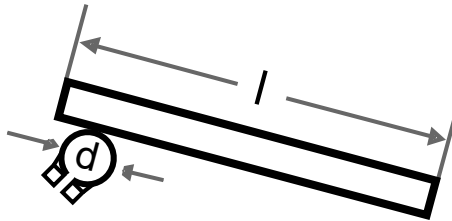

Article:

Order No.:

EUR
without
Tax

EUR
incl. 19%
Tax

	d	l			EUR without Tax	EUR incl. 19% Tax	
Clamps, from tube 22 mm Ø (7/8")							
Clamps	28	265	7994	LS N2 28	Pair	95,34	113,46
Dto., black			7675	LS N2 28, schwarz	Pair	95,34	113,46
Clamps	30	265	7990	LS N2 30	Pair	95,34	113,46
Dto., black			7676	LS N2 30, schwarz	Pair	95,34	113,46
Clamps	32	265	7992	LS N2 32	Pair	95,34	113,46
Dto., black			7677	LS N2 32, schwarz	Pair	95,34	113,46
Clamps	33	265	7997	LS N2 33	Pair	95,34	113,46
Dto., black			7678	LS N2 33, schwarz	Pair	95,34	113,46
Clamps	34	265	7944	LS N2 34	Pair	95,34	113,46
Dto., black			7688	LS N2 34, schwarz	Pair	95,34	113,46
Clamps	35	265	7995	LS N2 35	Pair	95,34	113,46
Dto., black			7679	LS N2 35, schwarz	Pair	95,34	113,46
Clamps	36	265	7946	LS N2 36	Pair	95,34	113,46
Dto., black			7680	LS N2 36, schwarz	Pair	95,34	113,46
Clamps	37	265	7945	LS N2 37	Pair	95,34	113,46
Dto., black			7681	LS N2 37, schwarz	Pair	95,34	113,46
Clamps	38	265	7998	LS N2 38	Pair	95,34	113,46
Dto., black			7682	LS N2 38, schwarz	Pair	95,34	113,46
Clamps	39	265	7638	LS N2 39	Pair	95,34	113,46
Dto., black			7639	LS N2 39, schwarz	Pair	95,34	113,46
Clamps	41	265	7640	LS N2 41	Pair	95,34	113,46
Dto., black			7641	LS N2 41, schwarz	Pair	95,34	113,46

Handlebar from tube 25,4 mm Ø (1")

Straight

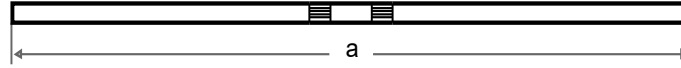

Article:	Order No.:	EUR without Tax	EUR incl. 19% Tax
	a		
Straight from tube 25,4 mm Ø (1")			
Straight	985 7010 Straight HD	Piece 46,85	55,75
Handlebar Straight from tube 25,4 mm Ø (1"), with notch for cables (For all HD from 82 up)			
Straight	985 7012 Straight HD MK	Piece 52,95	63,01
Dto., black	7051 Straight HD MK, schwarz	Piece 52,95	63,01
Straight 2	845 7019 Straight 2 HD MK	Piece 50,75	60,39

Drag Bars

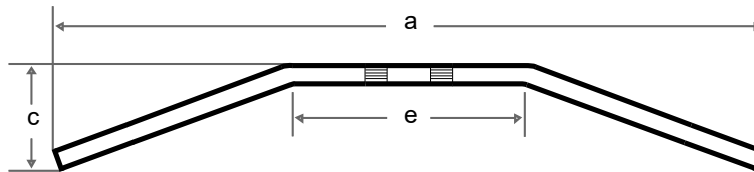

Article:	Order No.:	EUR without Tax	EUR incl. 19% Tax
	a c e		
Drag-Bars from tube 25,4 mm Ø (1")			
Drag-Bar, 820 mm wide	820 165 330 7091 L D 7 HD	Piece 52,95	63,01
Drag-Bar, 970 mm wide	970 165 345 7020 L D 9 HD	Piece 65,51	77,96
Drag-Bar, 1030 mm wide	1030 180 375 7031 L D 10 HD	Piece 65,51	77,96
Drag-Bars from tube 25,4 mm Ø (1"), with notch for cables (For all HD from 82 up)			
Drag-Bar, 635 mm wide	635 135 190 7088 L D 2 HD MK	Piece 52,95	63,01
Drag-Bar, 720 mm wide	720 165 230 7094 L D 3 HD MK	Piece 59,41	70,70
Drag-Bar, 820 mm wide	820 165 330 7092 L D 7 HD MK	Piece 61,61	73,32
Dto., black	820 165 330 7005 L D 7 HD MK, schwarz	Piece 61,61	73,32
Drag-Bar, 970 mm wide	970 165 345 7021 L D 9 HD MK	Piece 75,15	89,43
Dto., black	7218 L D 9 HD MK, schwarz	Piece 75,15	89,43
Drag-Bar, 1030 mm wide	1030 180 375 7032 L D 10 HD MK	Piece 75,15	89,43
Drag-Bar, 755 mm wide	755 65 310 7083 L D 11 HD MK	Piece 61,61	73,32
Drag-Bar, 780 mm wide	780 100 225 7001 L D 14 HD MK	Piece 61,61	73,32
Drag-Bar, 880 mm wide	880 120 225 7003 L D 15 HD MK	Piece 69,05	82,17
Drag-Bars from tube 25,4 mm Ø (1"), with notch for cables and 3hole cable inside wiring (1 long hole 13 x 30 in the cable notches and 1 long hole 13 x 40 in the middle of mounting place)			
For this handelbars, there is a technical report with one addendum for the 3 hole cable inside wiring			
Drag-Bar, 820 mm wide	820 165 330 7084 L D 7 HD MK 3LL	Piece 81,56	97,06
Dto., black	7085 L D 7 HD MK 3LL, schw.	Piece 81,56	97,06
Drag-Bar, 970 mm wide	970 165 345 7095 L D 9 HD MK 3LL	Piece 95,34	113,46
Dto., black	7097 L D 9 HD MK 3LL, schw.	Piece 95,34	113,46
Drag-Bar, 880 mm wide	880 120 225 7107 L D 15 HD MK 3LL	Piece 89,91	106,99
Dto., black	7111 L D 15 HD MK 3LL, schw.	Piece 89,91	106,99
Drag-Bar, 825 mm wide	825 170 280 7606 L D 20 HD MK 3LL	Piece 85,10	101,27
Dto., black	7607 L D 20 HD MK 3LL, schw.	Piece 85,10	101,27



7606 LD 20 HD MK 3LL

Drag-Bars from tube 25,4 mm Ø (1") with 4 slots for inside wiring together with hollow studs			
Drag-Bar, 880 mm wide	880 120 225 7002 L D 15 HD 4LL	Piece 90,83	108,09

Superbike Handlebar

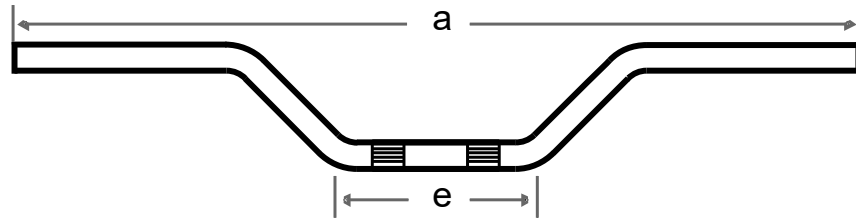
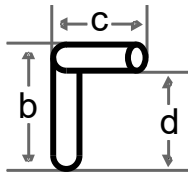

Article:						Order No.:		EUR without Tax	EUR incl. 19% Tax
	a	b	c	d	e				
Superbike-Handlebar from tube 25,4 mm Ø (1")									
Superbike-Handlebar	760	75	105	100	260	7034 LN 44 HD	Piece	59,41	70,70
Dto., black						7033 LN 44 HD schwarz	Piece	59,41	70,70
Superbike-Handlebar, wide	810	75	105	100	310	7035 LN 45 HD	Piece	61,31	72,96
Superbike-Handlebar from tube 25,4 mm Ø (1"), with notch for cables (For all HD from 82 up)									
Superbike-Handlebar,	760	75	105	100	260	7029 LN 44 HD MK	Piece	65,15	77,53
Superbike-Handlebar, wide	810	75	105	100	310	7058 LN 45 HD MK	Piece	68,08	81,02
Dto., black						7057 LN 45 HD MK, schwarz	Piece	68,08	81,02
Superbike-Handlebar, hoch, black	870	135	120	150	200	7059 LN 46 HD MK, schwarz	Piece	68,08	81,02
Superbike-Handlebar from tube 25,4 mm Ø (1"), with notch for cables and 3 holes for inside wiring (For HD 82 up) (1 long hole 13 x 30 in the cable notches and 1 long hole 13 x 40 in the middle of mounting place) For this handlebars, there is a Technical Report with one addendum for the 3 hole cable inside wiring									
Superbike-Handlebar wide	810	75	105	100	310	7139 LN 45 HD 3LL	Piece	90,83	108,09
Superbike-Handlebar wide, black						7140 LN 45 HD 3LL, schwarz	Piece	90,83	108,09

Touring Handlebars

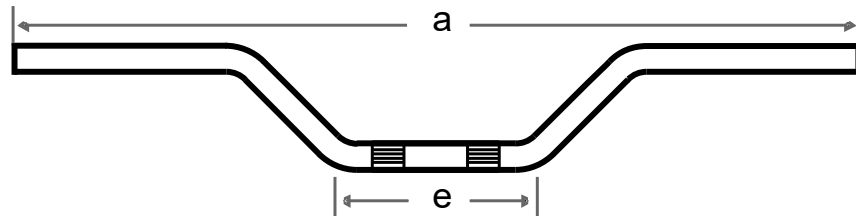
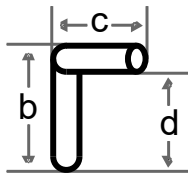

Article:						Order No.:		EUR without Tax	EUR incl. 19% Tax
	a	b	c	d	e				
Handlebar from tube 25,4 mm Ø (1")									
Handlebar, low and wide	920	100	110	70	250	7201 LN 33 HD	Piece	65,82	78,33
Handlebar from tube 25,4 mm Ø (1"), with notch for cables (For all HD from 82 up)									
Handlebar, low and wide	920	100	110	70	250	7208 LN 33 HD MK	Piece	75,15	89,43
Dto., black						7215 LN 33 HD MK, schwarz	Piece	75,15	89,43
Handlebar from tube 25,4 mm Ø (1"), with notch for cables (For all HD from 82 up) (1 long hole 13 x 30 in the cable notches and 1 long hole 13 x 40 in the middle of mounting place) For this handlebars, there is a Technical Report with one addendum for the 3 hole cable inside wiring									
Handlebar, low and wide	920	100	110	70	250	7217 LN 33 HD MK 3LL	Piece	96,32	114,62
Dto., black						7219 LN 33 HD MK 3LL, schwarz	Piece	96,32	114,62

Chopper- and Cruiser Handlebars

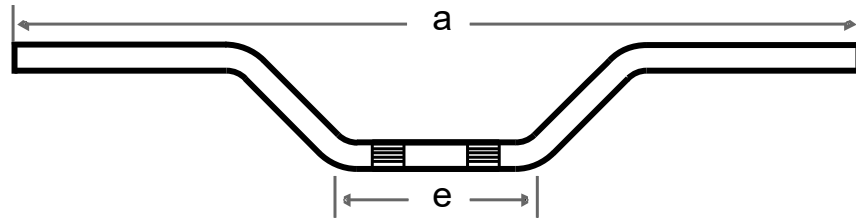
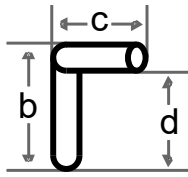

Article:	Order No.:					EUR without Tax	EUR incl. 19% Tax	
	a	b	c	d	e			
Handlebar from tube 25,4 mm Ø (1")								
Handlebar, medium high and wide	995	200	210	150	390	7207 LN 34 HD	Piece 81,25	96,69
Dto., black						7069 LN 34 HD schwarz	Piece 81,25	96,69
Handlebar, low and wide	920	60	150	25	220	7055 LN 42 HD	Piece 65,82	78,33
Dto., black						7070 LN 42 HD schwarz	Piece 65,82	78,33
Handlebar from tube 25,4 mm Ø (1"), with notch for cables (For all HD from 82 up)								
Classic and stylish Handlebar, high	830	250	170	230	280	7818 LN B HD MK	Piece 72,22	85,94
Handlebar, medium high and wide	995	200	210	150	390	7209 LN 34 HD MK	Stück 90,83	108,09
Handlebar, Design like HD E-Glide	885	165	255	145	370	7210 LN 35 HD MK	Piece 90,83	108,09
Dto., black						7071 LN 35 HD MK schwarz	Piece 90,83	108,09
Handlebar, low, wide, strong cranked	1010	70	290	90	275	7038 LN 36 HD MK	Piece 90,83	108,09
Handlebar, low, wide, very strong cranked	1050	120	350	200	250	7016 LN 37 HD MK	Piece 03,40	123,05
Handlebar, medium high and wide	990	125	220	130	230	7799 LN 40 HD MK	Piece 90,83	108,09
Handlebar, low and wide	990	90	195	160	235	7142 LN 41 HD MK	Piece 81,25	96,69
Handlebar, low and wide	920	60	150	25	220	7056 LN 42 HD MK	Piece 72,22	85,94
Handlebar, low and wide	930	90	200	80	195	7185 LN 49 HD MK	Piece 81,25	96,69
Handlebar, medium high and wide	1000	170	150	220	230	7146 LN 53 HD MK	Piece 81,25	96,69
Hb, medium high, wide, strong cranked	1020	160	275	120	395	7149 LN 56 HD MK	Piece 90,83	108,09
Handlebar, medium high, strong cranked	865	155	235	120	305	7150 LN 57 HD MK	Piece 81,25	96,69
Handlebar, medium high and wide	865	155	245	205	280	7023 LN 58 HD MK	Piece 90,83	108,09
Dto., black						7072 LN 58 HD MK schwarz	Piece 90,83	108,09
Handlebar, low and wide	950	65	115	-10	200	7099 LN 59 HD MK	Piece 81,25	96,69
Dto., black						7077 LN 59 HD MK schwarz	Piece 81,25	96,69
Handlebar, Classic high	905	280	195	210	260	7125 LN 60 HD MK	Piece 90,83	108,09
Dto., black						7124 LN 60 HD MK, schwarz	Piece 90,83	108,09
Handlebar from tube 25,4 mm Ø (1"), with notch for cables and 3 holes for inside wiring (For HD 82 up) (1 long hole 13 x 30 in the cable notches and 1 long hole 13 x 40 in the middle of mounting place) For this handelbars, there is a technical report with one addendum for the 3 hole cable inside wiring								
Classic and stylish Handlebar, high	830	250	170	230	280	7815 LN B HD MK 3LL	Piece 99,86	118,83
Dto., black						7816 LN B HD MK 3LL, schwarz	Piece 99,86	118,83
Handlebar, medium high and wide	990	125	220	130	230	7807 LN 40 HD MK 3LL	Piece 105,65	125,72
Dto., black						7808 LN 40 HD MK 3LL, schwarz	Piece 105,65	125,72
Handlebar, low and wide	920	60	150	25	220	7197 LN 42 HD MK 3LL	Piece 99,86	118,83
Dto., black						7198 LN 42 HD MK 3LL, schwarz	Piece 99,86	118,83
Handlebar, medium high and wide	865	155	245	205	280	7025 LN 58 HD MK 3LL	Piece 105,65	125,72
Dto., black						7026 LN 58 HD MK 3LL, schwarz	Piece 105,65	125,72
Handlebar, Classic high	905	280	195	210	260	7126 LN 60 HD MK 3LL	Piece 105,65	125,72
Dto., black						7127 LN 60 HD MK 3LL, schwarz	Piece 105,65	125,72
Handlebars from tube 25,4 mm Ø (1") with 4 slots for inside wiring together with hollow studs Risers								
Handlebar, low, wide, very strong cranked	1050	120	350	200	250	7061 LN 37 HD 4LL	Piece 126,15	150,12
Handlebar, medium high and wide	990	125	220	130	230	7067 LN 40 HD 4LL	Piece 105,65	125,72
Handlebar, low and wide	920	60	150	25	220	7068 LN 42 HD 4LL	Piece 99,86	118,83
Dto., black						7066 LN 42 HD 4LL schwarz	Piece 99,86	118,83

Article:	Order No.:					EUR without Tax	EUR incl. 19% Tax	
	a	b	c	d	e			
ULZ-Handlebar from tube 25,4 mm Ø (1") with notch for cables and 3hole inside wiring (For HD 82 up) (1 long hole 13 x 30 in the cable notches and 1 long hole 13 x 40 in the middle of mounting place)								
ULZ-Handlebar, low	770	300	175	230	270	7695 ULZ 2 HD MK 3LL	Piece 95,34	113,46
Dto., black						7696 ULZ 2 HD MK 3LL, schwarz	Piece 95,34	113,46
ULZ-Handlebar, high	770	400	175	330	270	7697 ULZ 3 HD MK 3LL	Piece 98,58	117,31
Dto., black						7698 ULZ 3 HD MK 3LL, schwarz	Piece 98,58	117,31



7695 ULZ 2 HD MK 3LL



7697 ULZ 3 HD MK 3LL

LSB-Handlebar from tube 25,4 mm Ø (1") with notch for cables and 3hole inside wiring (For HD 82 up) (1 long hole 13 x 30 in the cable notches and 1 long hole 13 x 40 in the middle of mounting place)								
Six Bend-Handlebar, medium high	805	320	115	230	265	7724 LSB 4 HD MK 3LL	Piece 103,40	123,05
Dto., black						7725 LSB 4 HD MK 3LL, schwarz	Piece 103,40	123,05
Six Bend-Handlebar, high	820	370	115	280	265	7726 LSB 5 HD MK 3LL	Piece 107,54	127,97
Dto., black						7727 LSB 5 HD MK 3LL, schwarz	Piece 107,54	127,97
Six Bend-Handlebar, low	760	275	165	200	270	7830 LSB 6 HD MK 3LL	Piece 109,13	129,87
Dto., black						7831 LSB 6 HD MK 3LL, schwarz	Piece 109,13	129,87
Six Bend-Handlebar, medium high	780	325	170	240	270	7832 LSB 7 HD MK 3LL	Piece 111,39	132,55
Dto., black						7833 LSB 7 HD MK 3LL, schwarz	Piece 111,39	132,55
Six Bend-Handlebar, high	800	375	180	270	270	7834 LSB 8 HD MK 3LL	Piece 114,92	136,76
Dto., black						7835 LSB 8 HD MK 3LL, schwarz	Piece 114,92	136,76



7724 LSB 4 HD MK 3LL



7726 LSB 5 HD MK 3LL



7830 LSB 6 HD MK 3LL



7832 LSB 7 HD MK 3LL



7834 LSB 8 HD MK 3LL

T-Bars

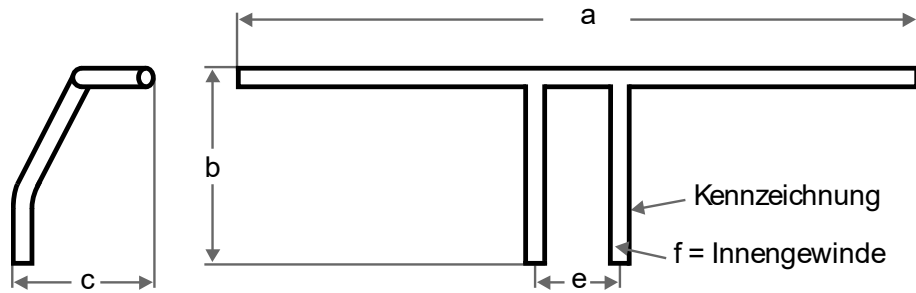

T-Bar handlebar with thread in the vertical tubes (hole distance 100 mm for many Japanese bikes). The handlebars are mounted with a screw from below on the triple tree. For some motorcycle models we have mounting kits, for other models you have to make the mounting like the description in the TÜV-technical report.

Article:		Order No.:		EUR without Tax	EUR incl. 19% Tax
T-Bar	a b c e f				
T-Bar Ø 25,4 mm	800 225 160 100 M 12	7950 T-Bar 1 HD	Piece	170,80	203,25
Mounting kits:					
Mounting kit for T-Bar Honda VT 750/1100 C2		7979 MK HO VT 750/1100 C2	Piece	22,45	26,72
Suzuki VZ 800 Marauder and Yamaha XV 1600 Wild Star					
Mounting kit for T-Bar Yamaha XVS 650/1100 Drag Star and XVS 650 Drag Star Classic		7965 MK YA XVS 650/1100 DS	Piece	33,73	40,14
Mounting kit for T-Bar Handlebar Yamaha XVS 1100 Drag Star Classic		7993 MK YA XVS 1100 DSC	Piece	22,45	26,72

M-Handlebar

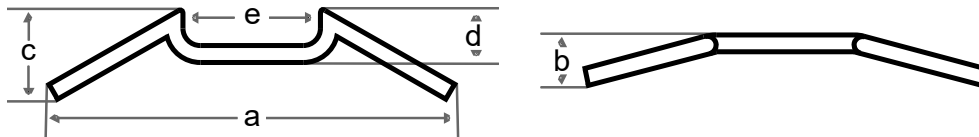

Article:		Order No.:		EUR without Tax	EUR incl. 19% Tax
M-Handlebar from tube 25,4 mm Ø (1"), with notch for cables (For all HD from 82 up)	a b c d e				
M-Handlebar 25,4 mm Ø	694 105 162 134 300	7308 HO L 10 HD MK	Piece	104,68	124,57
Dto., black		7307 HO L 10 HD MK, schwarz	Piece	104,68	124,57

Off-Road-Handlebar

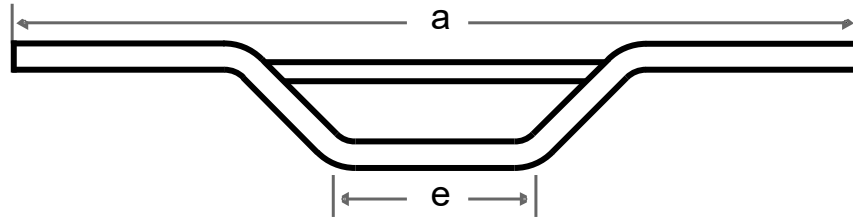
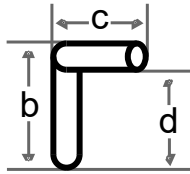

Article:

Order No.:

EUR
without
Tax

EUR
incl. 19%
Tax

Off-Road Handlebar from tube 25,4 mm Ø (1"), with notch for cables (For all HD from 82 up)

	a	b	c	d	e			EUR without Tax	EUR incl. 19% Tax
Off-Road-Handlebar, 25,4 mm, black	900	130	95	155	200	7214 CL N HD MK schwarz	Piece	77,35	92,05

Handlebars with strut

Article:

Order No.:

EUR
without
Tax

EUR
incl. 19%
Tax

Handlebars with strut from tube 25,4 mm Ø (1")
 with notch for cables and 3 holes for inside wiring (for all HD ab Bj. 82),
 (1 long hole 13 x 30 in the cable notches and 1 long hole 13 x 40 in the middle of mounting place)

	a	b	c	d			EUR without Tax	EUR incl. 19% Tax	
Handlebar with rounded strut	880	60	200	-40	190	7660 CL 7 HD MK 3LL	Piece	101,44	120,71
Dto., black						7661 CL 7 HD MK 3LL, schwarz	Piece	101,44	120,71
Handlebar with rounded strut Ø 12 mm	870	145	205	160	230	7654 CL 9 HD MK 3LL	Piece	101,44	120,71
Dto., black						7655 CL 9 HD MK 3LL, schwarz	Piece	101,44	120,71
Handlebar with rounded strut Ø 22 mm	870	145	205	160	230	7670 CL 10 HD MK 3LL	Piece	101,44	120,71
Dto., black						7672 CL 10 HD MK 3LL, schwarz	Piece	101,44	120,71
Handlebar with rounded strut, black						7657 CL 12 HD MK 3LL, schwarz	Piece	101,44	120,71
High-Drag Bar	870	110	120	100	200	7662 CL 13 HD MK 3LL	Piece	101,44	120,71
Dto., black						7663 CL 13 HD MK 3LL, schwarz	Piece	101,44	120,71
Handlebar round top, below squared	895	150	250	125	280	7666 CL 18 HD MK 3LL	Piece	126,51	150,55
Dto., black						7668 CL 18 HD MK 3LL, schwarz	Piece	126,51	150,55



7661 CL 7 HD MK 3LL



7654 CL 9 HD MK 3LL



7670 CL 10 HD MK 3LL



7657 CL 12 HD MK 3LL, schwarz



7663 CL 13 HD MK 3LL



7668 CL 18 HD MK 3LL

Z-Handlebar

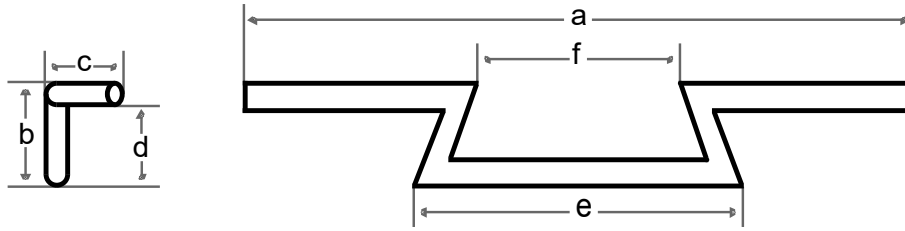

Z-Handlebar from tube 25,4 mm Ø (1").

Article:

Order No.:

	a	b	c	d	e			EUR without Tax	EUR incl. 19% Tax
Z-Handlebar, high	620	280	80	220	220	7730	L Z 11 HD	Piece 197,76	235,33
Dto., black						7731	L Z 11 HD schwarz	Piece 197,76	235,33



7730 L Z 11 HD



LZ 10 HD, LZ 9 HD, LZ 7 HD

Article:

Order No.:

	a	b	c	d	e			EUR without Tax	EUR incl. 19% Tax
Z-Handlebar for Chopper and Cruiser from tube 25,4 mm Ø									
with notch for cables and 3 holes for inside wiring (for all HD ab Bj. 82),									
(1 long hole 13 x 30 in the cable notches and 1 long hole 13 x 40 in the middle of mounting place)									
Z-Handlebar, low, small, black	870	85	120	50	300	7752	L Z 7 HD MK 3LL, schw.	Piece 199,71	237,66
Z-Handlebar, high, small,	850	145	120	110	300	7766	L Z 9 HD MK 3LL	Piece 199,71	237,66
Dto., black						7758	L Z 9 HD MK 3LL, schw.	Piece 199,71	237,66
Z-Handlebar, high, wide, black	900	145	120	110	350	7761	L Z 10 HD MK 3LL, schw.	Piece 199,71	237,66
Z-Handlebar, with open tube ends, black	755	265	90	155	240	7717	L Z 13 HD MK 3LL, schwarz	Piece 190,08	226,20
Z-Handlebar	685	245	115	140	250	7718	L Z 14 HD MK 3LL	Piece 204,84	243,76
Dto., black						7719	L Z 14 HD MK 3LL, schwarz	Piece 204,84	243,76
Z-Handlebar	780	145	95	30	250	7113	BZ 3 HD MK 3LL	Piece 204,84	243,76
Dto., black						7114	BZ 3 HD MK 3LL, schwarz	Piece 204,84	243,76



7717 L Z 13 HD MK 3LL, schwarz



7718 L Z 14 HD MK 3LL



7113 BZ 3 HD MK 3LL

LZR and LRZ Lenker

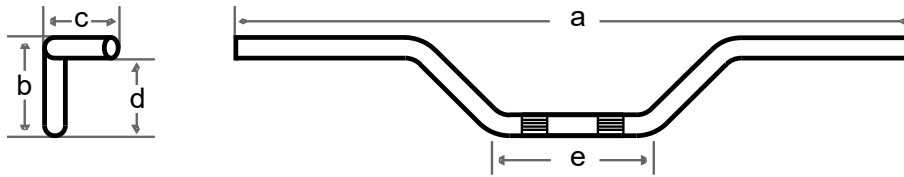

Handlebars from tube 25,4 mm Ø (1"), with notch for cables and 3 holes for inside wiring (for all HD ab Bj. 82), (1 long hole 13 x 30 in the cable notches and 1 long hole 13 x 40 in the middle of mounting place)

Article:	a	b	c	d	e	Order No.:		EUR without Tax	EUR incl. 19% Tax
LZR-Handlebar from tube 25,4 mm Ø (1")									
Z-Handlebar, low, round top	770	150	95	120	235	7800 L ZR 3 HD MK 3LL	Piece	177,21	210,88
Dto., black						7801 L ZR 3 HD MK 3LL, schw.	Piece	177,21	210,88
LRZ-Handlebar from tube 25,4 mm Ø (1")									
Z-Handlebar, high, below round	765	310	120	205	260	7693 L RZ 2 HD MK 3LL	Piece	188,12	223,86
Dto., black						7694 L RZ 2 HD MK 3LL, schw.	Piece	188,12	223,86



7800 L ZR 3 HD MK 3LL



7693 L RZ 2 HD MK 3LL

Fatbars 31,75 mm Ø (1 1/4") (Grip Ends and Mounting Point from tube 25,4 mm Ø (1"))

Handlebars for Choppers and Cruisers from tube 31,75 mm Ø (1 1/4") with 25,4 mm Ø (1") grip ends and clamp area. Length of the grip ends 200 mm, with notch for cables and 3 holes for inside wiring. (For all HD from 82 up) (1 long hole 13 x 30 in the cable notches and 1 long hole 13 x 40 in the middle of mounting place)

Article:	a	b	c	d	e	Order No.:		EUR without Tax	EUR incl. 19% Tax
Handlebar round top, below angular	890	100	250	145	285	7665 CL 20 FB MK 3LL	Piece	204,84	243,76
Dto., black						7669 CL 20 FB MK 3LL, schwarz	Piece	204,84	243,76
Drag-Bar, 825 mm wide	825		170		280	7720 L D 20 FB MK 3LL	Piece	180,13	214,36
Dto., black						7721 L D 20 FB MK 3LL, schw.	Piece	180,13	214,36



7669 CL 20 FB MK 3LL



7669 HD Street Bob



7721 LD 20 FB MK 3LL

Fatbars 31,75 mm Ø (1 1/4") (Grip ends from tube 25,4 mm Ø (1"))

Handlebars for Choppers and Cruisers from tube 31,75 mm Ø (1 1/4") with butted grip ends 25,4 mm Ø (1"). Length of the grip ends 200 mm, with notch for cables (For all HD from 82 up) and 3 holes for inside wiring.

(1 long hole 13 x 30 in the cable notches and 1 long hole 13 x 40 in the middle of mounting place)

Model for Harley-Davidson with Throttle by Wire (TBW) with 3 holes for inside wiring.

(1 long hole 13 x 30 in the cable notches and 1 long hole 13 x 40 in the middle of mounting place)



With notch and 3 long holes



With 3 long holes for Harley-Davidson and throttle by wire (TBW)

Drag Bars

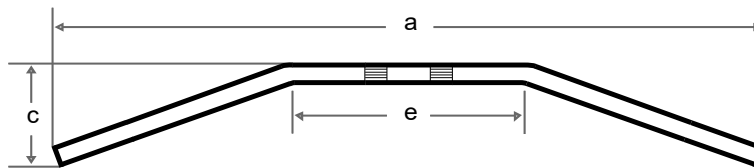

Article:

Order No.:

	a	c	e			EUR without Tax	EUR incl. 19% Tax
Drag-Bars from tube 31,75 mm Ø (1 1/4") with butted grip ends 25,4 mm Ø (1")							
Drag-Bar, 970 mm wide	970	175	330	7652	L D 9 HDF	Piece 173,36	206,30
Dto., black				7653	L D 9 HDF, schwarz	Piece 173,36	206,30
Drag-Bar, 870 mm wide	870	175	230	7650	L D 19 HDF	Piece 157,32	187,21
Dto., black				7651	L D 19 HDF, schwarz	Piece 157,32	187,21
Drag-Bar, 825 mm wide	825	170	280	7622	L D 20 HDF	Piece 161,47	192,15
Dto., black				7623	L D 20 HDF, schwarz	Piece 161,47	192,15
Drag-Bars from tube 31,75 mm Ø (1 1/4") with butted grip ends 25,4 mm Ø (1"). Model for Harley-Davidson with Throttle by Wire (TBW)							
Drag-Bar, 970 mm wide	970	175	330	7263	L D 9 HDF-E	Piece 204,53	243,39
Dto., black				7264	L D 9 HDF-E, schwarz	Piece 204,53	243,39
Drag-Bar, 825 mm wide	825	170	280	7624	L D 20 HDF-E	Piece 192,33	228,87
Dto., black				7625	L D 20 HDF-E, schwarz	Piece 192,33	228,87



7652 L D 9 HDF



7650 L D 19 HDF



7623 L D 20 HDF, black

Of the handlebars 7652 LD 9 HDF, 7650 LD 19 HDF and 7651 LD 19 HDF black handlebars are still in stock with 5-hole cable inside wiring (1 long hole 10 x 20 in the cable notch in the area of the grips, 2 x in the area of the clamping points (transverse holes for a larger adjustment range when routing the cable through the risers) and 1 x centrally between the clamping points). Newly manufactured Fatbars are converted to the current 3-hole cable routing.

Handlebars for Choppers and Cruisers

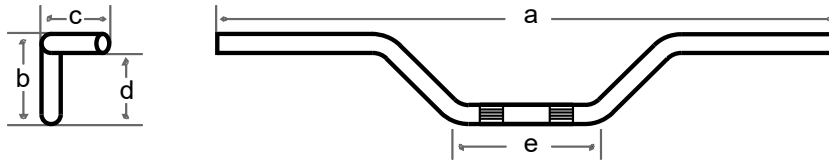

Article:	Order No.:					EUR without Tax	EUR incl. 19% Tax	
	a	b	c	d	e			
Handlebars from tube 31,75 mm Ø (1 1/4") with butted grip ends 25,4 mm Ø (1")								
Small Ape-Hanger, low	980	310	240	220	285	7608 LN 61 HDF	Piece 238,21	283,47
Dto., black						7609 LN 61 HDF schwarz	Piece 238,21	283,47
Small Ape-Hanger, medium high	1010	410	240	320	285	7610 LN 62 HDF	Piece 266,81	317,50
Dto., black						7611 LN 62 HDF schwarz	Piece 266,81	317,50
Fatbar low, wide, extra strong cranked	930	185	225	410	345	7179 LN 66 HDF	Piece 238,21	283,47
Dto., black						7180 LN 66 HDF schwarz	Piece 238,21	283,47
Handlebar, low, wide, strong cranked	990	65	305	60	270	7348 LN 68 HDF	Piece 213,50	254,07
Dto., black						7349 LN 68 HDF schwarz	Piece 213,50	254,07
Handlebar, low and wide	995	65	200	115	180	7632 LN 69 HDF	Piece 195,51	232,66
Dto., black						7633 LN 69 HDF schwarz	Piece 195,51	232,66
Handlebar, low and wide, black	1070	70	225	125	180	7635 LN 70 HDF schwarz	Piece 195,51	232,66
Handlebar, low and wide, black	1000	65	230	120	215	7637 LN 71 HDF schwarz	Piece 195,51	232,66
Handlebar, medium high and wide, black	1030	130	250	110	200	7321 LN 72 HDF schwarz	Piece 213,50	254,07
Handlebars from tube 31,75 mm Ø (1 1/4") with butted grip ends 25,4 mm Ø (1"). Model for Harley-Davidson with Throttle by Wire (TBW)								
Small Ape-Hanger, low	980	310	240	220	285	7602 LN 61 HDF-E	Piece 269,01	320,12
Dto., black						7603 LN 61 HDF-E schwarz	Piece 269,01	320,12
Small Ape-Hanger, medium high	1010	410	240	320	285	7265 LN 62 HDF-E	Piece 297,92	354,53
Dto., black						7266 LN 62 HDF-E schwarz	Piece 297,92	354,53
Handlebar, low and wide	995	65	200	115	180	7268 LN 69 HDF-E	Piece 226,31	269,31
Dto., black						7269 LN 69 HDF-E schwarz	Piece 226,31	269,31
Handlebar, low and wide	1000	65	230	120	215	7270 LN 71 HDF-E	Piece 226,31	269,31
Dto., black						7272 LN 71 HDF-E schwarz	Piece 226,31	269,31



7608 LN 61 HDF



7610 LN 62 HDF



7179 LN 66 HDF



7348 LN 68 HDF



7632 LN 69 HDF



LN 70 HDF



LN 71 HDF



LN 72 HDF

Of the handlebars 7609 LN 61 HDF black, 7611 LN 62 HDF black, 7179 LN 66 HDF, 7180 LN 66 HDF black, 7346 LN 67 HDF, 7348 LN 68 HDF and 7349 LN 68 HDF black, there is still stock with 5-hole cable inside wiring (1 long hole 10 x 20 in the cable notch in the area of the grips, 2 x in the area of the clamping points (transverse holes for a larger adjustment range when routing the cable through the risers) and 1 x centrally between the clamping points). Newly manufactured Fatbars are converted to the current 3-hole cable inside wiring.

Six Bend Fatbars

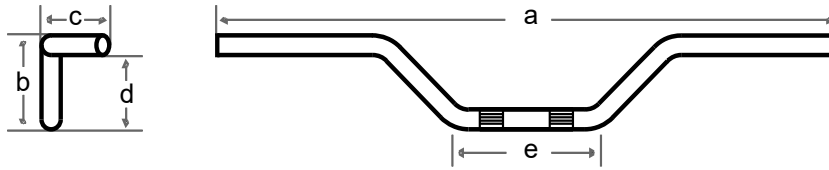

Article:

Order No.:

Handlebars from tube 31,75 mm Ø (1 1/4") with butted grip ends 25,4 mm Ø (1").

Six Bend Ape-Hanger, high
 Dto., black

a	b	c	d	e
825	430	220	350	310

7689 L SB 9 HDF
 7690 L SB 9 HDF, schwarz

Piece 279,93
 Piece 279,93

EUR without Tax	EUR incl. 19% Tax
279,93	333,12



7689 L SB 9 HDF

Z-Handlebar

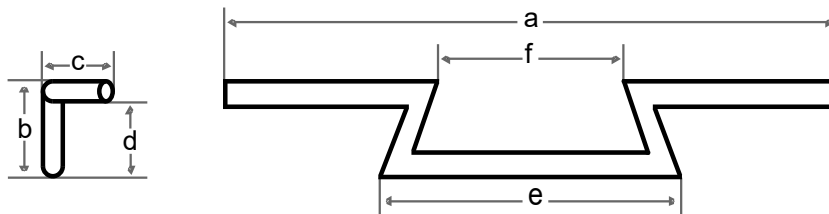

Article:

Order No.:

Z-Fatbar from tube 31,75 mm Ø (1 1/4") with grip ends 25,4 mm Ø (1").

Z-Fatbar, low, small, black
 Z-Fatbar, high, small,

a	b	c	d	e
870	85	120	50	300
850	145	120	110	300

7750 L Z 7 HDF, schwarz
 7757 L Z 9 HDF

Piece 274,20
 Piece 274,20

EUR without Tax	EUR incl. 19% Tax
274,20	326,30



7757 L Z 9 HDF

7750 L Z 7 HDF, black



MSP-Handlebars with ABE

without modification acceptance

For the MSP-Handlebars with ABE exists a use list with models of Chopper, Cruiser and Classic Bikes from Harley-Davidson, Honda, Kawasaki, Suzuki, Triumph, Victory and Yamaha.

MSP-CrackBars

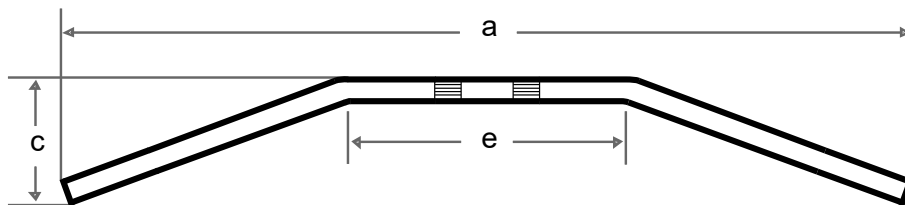

Article:

Order No.:

EUR without Tax	EUR incl. 19% Tax
-----------------------	-------------------------

	a	c	e			EUR without Tax	EUR incl. 19% Tax
CrackBars from tube 25,4 mm Ø (1"), with notch for cables (For all HD from 82 up)							
CrackBar, 800 mm wide, black	800	120	240	6240	MSP-RL-1-B1-B-A-C schw.	Piece 84,73	100,83
CrackBar, 850 mm wide	850	110	260	6151	MSP-RL-1-B1-B-B-B	Piece 84,73	100,83
Dto., black				6152	MSP-RL-1-B1-B-B-B, schw.	Piece 84,73	100,83
CrackBars from tube 31,75 mm Ø (1 1/4") with butted grip ends 25,4 mm Ø (1") and 5 holes for inside wiring							
CrackBar, 850 mm wide	850	110	260	6161	MSP-RL-1-B2-F-B-B	Piece 177,51	211,24
Dto., black				6162	MSP-RL-1-B2-F-B-B, schw.	Piece 177,51	211,24

MSP-CustomBars and -RaceBars

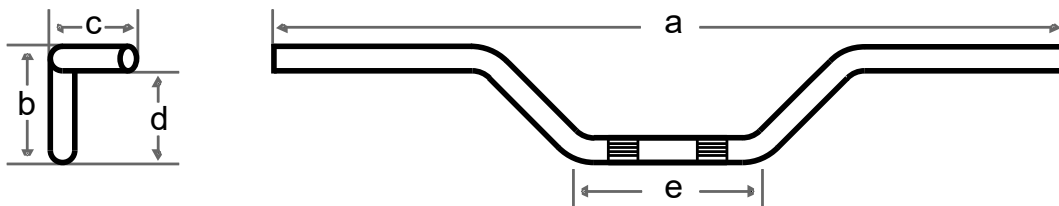

Article:

Order No.:

EUR without Tax	EUR incl. 19% Tax
-----------------------	-------------------------

	a	b	c	d	e			EUR without Tax	EUR incl. 19% Tax
CustomBars from tube 25,4 mm Ø (1"), with notch for cables (For all HD from 82 up)									
CustomBar	850	60	100	30	170	6159	MSP-RL-1-A1-B-B-B	Piece 94,37	112,30
Dto., black						6160	MSP-RL-1-A1-B-B-B, schw.	Piece 94,37	112,30
CustomBar, high, black	800	90	115	80	160	6241	MSP-RL-1-A3-B-A-C schw.	Piece 97,91	116,51
CustomBar, high	850	90	100	60	185	6149	MSP-RL-1-A3-B-B-B	Piece 97,91	116,51
Dto., black						6150	MSP-RL-1-A3-B-B-B, schw.	Piece 97,91	116,51
CustomBar	850	60	100	-10	170	6147	MSP-RL-1-A1-B-B-C	Piece 94,37	112,30
Dto., black						6148	MSP-RL-1-A1-B-B-C, schw.	Piece 94,37	112,30
RaceBars from tube 25,4 mm Ø (1"), with notch for cables (For all HD from 82 up)									
RaceBar	850	60	100	50	170	6153	MSP-RL-1-D1-B-B-C	Piece 94,37	112,30
Dto., black						6154	MSP-RL-1-D1-B-B-C, schw.	Piece 94,37	112,30

MSP-ZBars

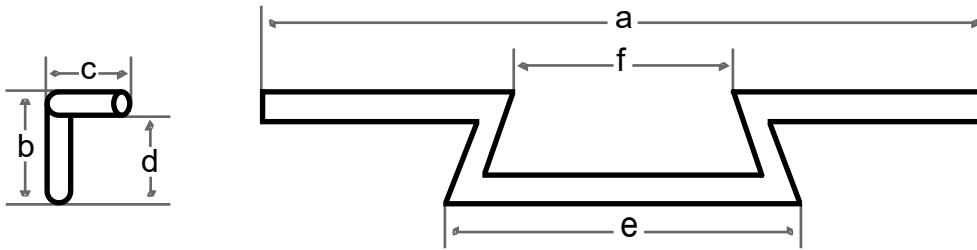

Article:

Order No.:

	a	b	Tax	Tax	e				EUR without Tax	EUR incl. 19% Tax	
ZBars from tube 25,4 mm Ø (1"), with notch for cables (For all HD from 82 up)											
ZBar, low, black	800	70	110	40	265	6242	MSP-RL-1-Z1-B-A-C	schw.	Piece	192,33	228,87
ZBar, low	850	70	90	40	285	6155	MSP-RL-1-Z1-B-B-B		Piece	192,33	228,87
Dto., black						6156	MSP-RL-1-Z1-B-B-B, schw.		Piece	192,33	228,87
ZBar, high, black	800	110	110	80	265	6243	MSP-RL-1-Z2-B-A-C	schw.	Piece	196,48	233,81
ZBar, high	850	110	90	80	285	6157	MSP-RL-1-Z2-B-B-B		Piece	196,48	233,81
Dto., black						6158	MSP-RL-1-Z2-B-B-B, schw.		Piece	196,48	233,81
ZBars from tube 31,75 mm Ø (1 1/4"), with butted grip ends 25,4 mm Ø (1") and 5 holes for inside wiring											
ZBar, high black	850	110	90	80	300	6166	MSP-RL-1-Z4-F-B-B, schw.		Piece	304,33	362,15



CrackBar 6162 MSP-RL-1-B2-F-B-B
 CrackBar 6151 MSP-RL-1-B1-B-B-B



ZBar 6158 MSP-RL-1-Z2-B-B-B
 ZBar 6155 MSP-RL-1-Z1-B-B-B



CustomBar 6150 MSP-RL-1-A3-B-B-B
 CustomBar 6160 MSP-RL-1-A1-B-B-B

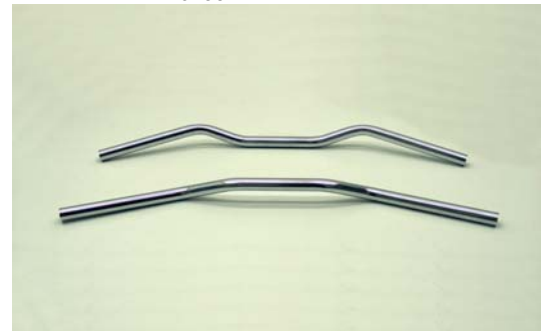

CustomBar 6147 MSP-RL-1-A1-B-B-C
 RaceBar 6153 MSP-RL-1-D1-B-B-C



ZBar 6243 MSP-RL-1-Z2-B-A-C black
 ZBar 6242 MSP-RL-1-Z1-B-A-C black
 CustomBar 6241 MSP-RL-1-A3-B-A-C black
 CrackBar 6240 MSP-RL-1-B1-B-A-C black

Information on handlebars, risers and technical reports

Handlebar recommendation:

The choice of handlebars depends on the physical characteristics of the rider, the desired riding position and other factors and add-on parts such as risers, triple clamps, footrest system, seat, handlebar riser kits etc.. For this reason, we cannot make any recommendations when selecting handlebars.

Does the handlebar fit with the original brake lines, cables and electric cables?

We have no information about which handlebars can be fitted on which motorcycle with the original brake lines, cables and electric cables, or whether they need to be extended. We recommend that you seek advice from an experienced workshop.

Handlebars with ABE (without approval) are an exception. In this case, the handlebars fit the motorcycles listed in the usage list without further modifications if the motorcycle is in its original condition.

Mounting the fittings:

Our handlebars have no holes for fixing the fittings and no threads for handlebar weights. Depending on the desired position of the fittings, holes for fixing the fittings must be drilled by the rider.

Commercially available handlebar weights with a clamping device can be fitted.

Shortening the grip ends on our handlebars:

We have no objections to shortening the handlebar ends. The prerequisite is that the grip ends are shortened by the same length on both sides and that the remaining grip piece is long enough to accommodate the fittings.

We recommend that you discuss any shortening with the inspector beforehand. If the installation instructions listed in the TGA / TB are observed, we have no objections to registration.

Handlebar holder / riser:

The clamping diameter must correspond to the handlebar diameter.

Expert technical reports:

You can download current TGA / TB on our website under "Service". In each TGA / TB you will find a list of the points that need to be observed during a conversion.

Some handlebars are supplied with 2 certificates. In the TGA the handlebar is tested, in the TB the extension for the special variant of the handlebar is included or an alternative type number.

On the reverse you will find a list of the different types of certificates with information on which inspectors are permitted to carry out the registrations.

Dimensions: Technical dimensions

- a Overall width
- b Height at the end of the outer bend, with vertical handlebars.
(The dimensions in the mounting position may vary considerably)
- c Depth to the rear, with vertical handlebars.
(The dimensions in the mounting position may vary considerably)
- d Height at the end of the grip, with handlebars in vertical position.
(The dimensions in the mounting position may vary considerably)
- e Measured at the intersection of the outer edges of the tubes

1. TB (Technical Report) according to § 19/2

The inspectors of TÜV, Dekra, GTÜ and other organizations who are trained as
AAS (Officially recognized expert)
AASMT (Officially recognized expert with partial authorization)
USB (Authorized Technical Service)
may carry out an attachment test with individual assessment.

2. TGA (with restriction to certain motorcycle models) according to § 19/3.
(From 2004, new TGAs may only be created with the restriction to certain motorcycle models)**a. The motorcycle is listed for the handlebars**

The inspectors of TÜV, Dekra, GTÜ and other organizations who have been trained as
AAS (Officially recognized expert)
AASMT (Officially recognized expert with partial authorization)
USB (Authorized Technical Service)
PI (Test engineer)
are authorized to carry out an attachment test.

b. The motorcycle is not listed for the handlebars

The inspectors of TÜV, Dekra, GTÜ and other organizations who have been trained as
AAS (Officially recognized expert)
AASMT (Officially recognized expert with partial authorization)
USB (Authorized Technical Service)
may carry out an attachment test with individual assessment.

3. TGA (without restriction to motorcycle models) according to § 19/3
(Until the end of 2003, TGAs could be issued without restriction to certain motorcycle models)

These parts certificates have the intended use "universal" according to
handlebar tube diameter and / or
Motorcycles with vehicle and body type
09 (motorcycle, light motorcycle, moped, mokick),
19 (motorcycle with sidecar)
25 (motorcycles)
and are not restricted to certain motorcycle models.

The inspectors from TÜV, Dekra, GTÜ and other organizations who have been trained as
AAS (officially recognized expert)
AASMT (officially recognized expert with partial authorization)
USB (Authorized Technical Service)
PI (test engineer)
are authorized to carry out an attachment test.

4. ABE (without mounting test)

(Can only be issued if the handlebars can be fitted without further modifications).

The motorcycle is listed for the handlebars:

No fitting test necessary, the ABE must be carried.

The motorcycle is not listed for the handlebars:

Acceptance as under point 1.

Many testing organizations also accept an attachment test as under point 3.

If several items are combined (handlebars, risers, brake lines, etc.), an installation test must always be carried out in accordance with § 19/2.

Options of manufacturing

We are your powerful partner for the development and production of articles made from bended tubes, also in small series from 25 or 50 pieces (No one-off production).

Special for tubes with 12, 14, 16, 18, 22, 25, 25,4 (1"), 30, 31,75 (1¼"), 32 and 38 (1 ½") mm Ø and rounded flat steel in 15, 20, 25, 30, 35 and 40 mm width we have a large stock from tools and material.

For all articles we can make a high-brilliant nickel and chromium plating in our own galvanisation. Alternatively powder coating in RAL colors is possible.

We are certified in pursuance of DIN EN ISO 9001.

Tube bending works from steel-roundtubes on

2 CNC mandrel bending machines up to 42 mm Ø, 1 x right- 1 x left-bending
1 CNC mandrel bending machine up to 42 mm Ø with freeform bending device,
several tool levels, right and left bending

Tube end forming up to 40 mm Ø x 100 mm lengths

for example ring-shapes, widening, reduction,
insert from nuts or turned parts

Rotary swaging up to 35 mm Ø and 350 mm lengths

for tapering of tubes

Punching and pressing up to 50 t.

Brazing (Gasflux-process)

Gas-shielded welding (MIG/MAG and WIG)

Orbital welding (WIG up to 40 mm Ø)

High precise plasmacutting (up to 20 mm)

from steel, stainless steel and aluminium
also in combination with drilling and thread cutting

Sheet Metal Processing CNC controlled press brake up to 35 to.

Storage and shipping

We can handle by appointment for you

Nickel and chromium plating (also in subcontracting)

of rack goods from steel, brass, copper, stainless steel and aluminium
by maximum measures of 950 x 750 x 300 mm.

If you are interested we are expecting your request.

Price- and Shipping Information

Prices incl. 19% tax are valid in Germany for private customers and in the EU for all customers without VAT number.

Prices without tax are valid in Germany for trade, handicraft and business, in the EU for all customers with VAT number and for all customers outside EU.

	EUR without Tax	EUR incl. 19 % Tax
Shipping costs Germany:		
Parcel (max. 30 kg)	8,15	9,70
Payment by direct debit with indication of IBAN less 2% discount Payment in advance (Bank transfer or Paypal) Account details by E-mail when ready for shipping.		
Parcel (max. 30 kg) by Cash on Delivery less 3% discount Only with recipient e-mail address!	12,35	14,70
Free shipping from:	250,00	297,50

Shipping costs for all EU-Countries:

Parcel (max 30 kg) From EUR 250,00	16,60 8,45	19,75 10,05
--	----------------------	-----------------------

Shipping costs for Swiss:

Parcel (max 30 kg) From EUR 250,00	18,40 10,25
--	-----------------------

Shipping costs for Great Britain:

Parcel (max 30 kg) From EUR 250,00	22,65 14,50
--	-----------------------

Payment in advance (Bank transfer or Paypal)
 Account details by E-mail when ready for shipping.

Shipping costs for other countries please ask.

**Sales in Belgien, Japan and Czech Republik
 only by our Exclusiv Importers.**



www.fehling.de

Ernst Fehling GmbH & Co. Metallwarenfabrik

Mendener Straße 1

58739 Wickede (Ruhr) - Germany

Tel. +49 (0) 23 77 - 20 33

Fax +49 (0) 23 77 - 16 35

eMail info@fehling.de